

COURTYARD SURFACE LEGEND

A	PLAY IT POURED IN PLACE RUBBER SURFACING STANDARD COLOR: BLUE THE RECREATIONAL GROUP, DALTON, GA (877) 881-8477 www.playsurfacing.com
B	PLAY IT POURED IN PLACE RUBBER SURFACING PREMIUM COLOR: PURPLE THE RECREATIONAL GROUP, DALTON, GA (877) 881-8477 www.playsurfacing.com
C	PLAY IT POURED IN PLACE RUBBER SURFACING PREMIUM COLOR: PINK THE RECREATIONAL GROUP, DALTON, GA (877) 881-8477 www.playsurfacing.com
D	SYNTHETIC TURF - FRINCE TURF 100% NYLON FIBER W/ HOLE-PUNCHED URETHANE BACKING X-GRASS, DALTON, GA (877) 881-8477 www.xgrass.com

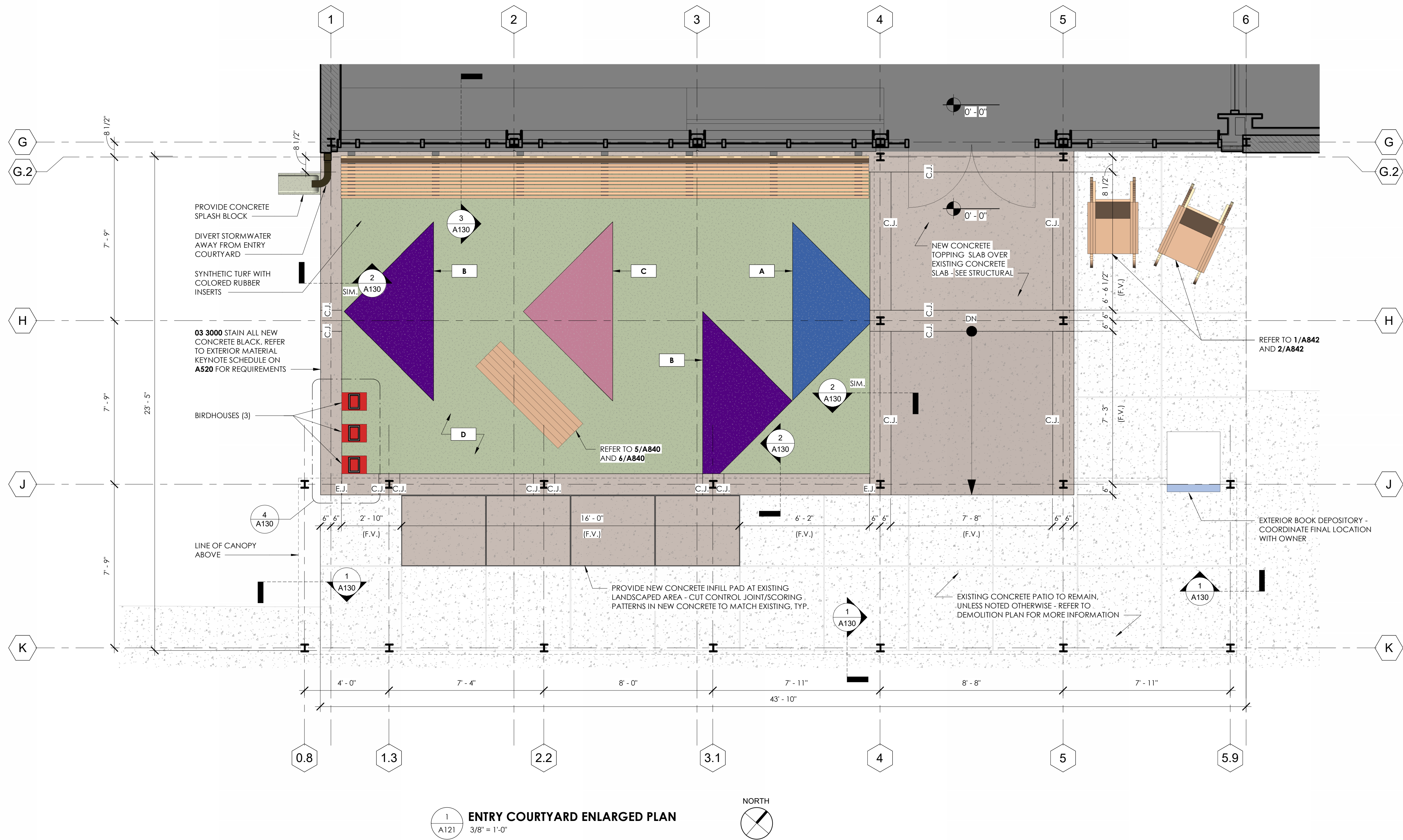

SHEET SPECIFIC NOTES

- ALL CONCRETE SIDEWALKS TO HAVE A **LIGHT BROOM** FINISH PERPENDICULAR TO LINE OF TRAVEL WITH **ROCK SALT FINISH**.
- CONTRACTOR TO LOCATE ALL EXISTING UTILITIES AND RELOCATE AS REQUIRED TO NOT INTERFERE WITH NEW CONSTRUCTION.
- ALL AREAS OF LANDSCAPE INSTALLATION TO HAVE SOIL PREPARED IN ACCORDANCE WITH **PLANTER SOIL SPECIFICATIONS**.
- EJ = EXPANSION JOINT. REFER TO DETAIL **6/A130**.
- CJ = CONTROL JOINT. REFER TO DETAIL **5/A130**.
- REFER TO **1110** FINISH LEGEND FOR **WD-2** SPECIFICATIONS AND PAINT SPECIFICATIONS.

CONCRETE STAIN SPECIFICATIONS

- ALL EXTERIOR CONCRETE TO BE RUBBED SMOOTH AND STAINED. REFER TO **A520** EXTERIOR MATERIAL KEYNOTE SCHEDULE FOR MORE INFORMATION.

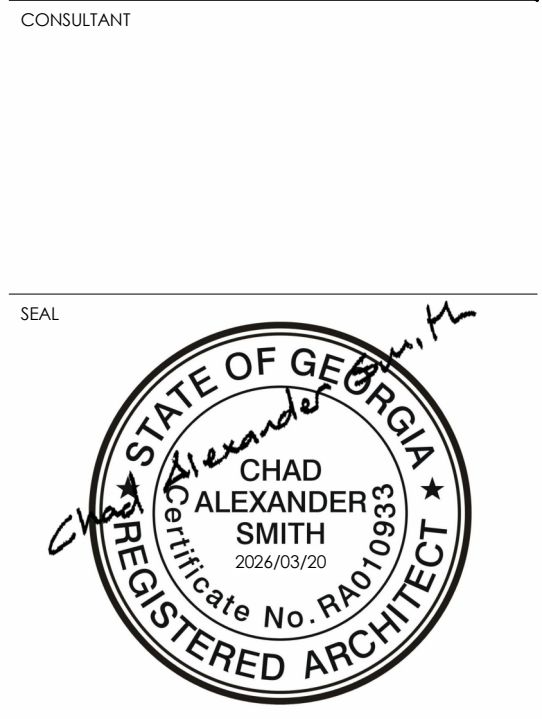
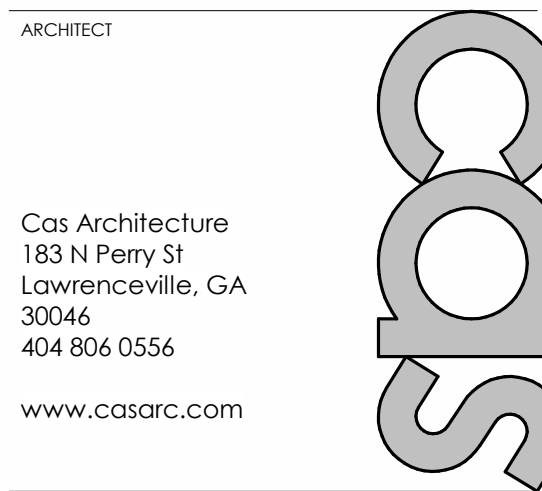

IF SEALED, DO NOT COPY

PROJECT

COLLINS P. LEE MEMORIAL LIBRARY
237 HARRISBURG ROAD SW, MILLEDGEVILLE, GA 31061

COPYRIGHT © 2024 CAS ARCHITECTURE, P.C. ALL RIGHTS RESERVED. THIS DOCUMENT AND ANY REPRODUCTIONS IN WHOLE OR IN PART, ARE INSTRUMENTS OF SERVICE AND ARE THE SOLE PROPERTY AND COPYRIGHT OF CAS ARCHITECTURE, P.C. AND MAY NOT BE REPRODUCED, COPIED, PUBLISHED, USED OR CONVEYED IN ANY MANNER WITHOUT WRITTEN PERMISSION FROM CAS ARCHITECTURE, P.C. THESE DOCUMENTS HAVE BEEN PREPARED SPECIFICALLY FOR THIS PROJECT. THEY ARE NOT SUITABLE FOR USE ON OTHER PROJECTS OR IN OTHER LOCATIONS.

THIS DOCUMENT WAS CREATED ELECTRONICALLY. THIS MEDIA SHOULD NOT BE CONSIDERED A CERTIFIED DOCUMENT UNLESS IT HAS BEEN PROPERLY SEALED AND ORIGINALLY SIGNED BY A REGISTERED ARCHITECT OF CAS ARCHITECTURE, P.C.

THESE PLANS ARE COMPLEMENTARY. THEREFORE THE CONTRACTOR SHALL SEE THE ARCHITECTURAL, STRUCTURAL, MECHANICAL, PLUMBING, AND ELECTRICAL PLANS AND SPECIFICATIONS, WHEN EXERCISED BY ANY ONE SHALL BE BINDING AS REQUIRED BY ALL THE INTENTION OF THE DOCUMENTS. THE CONTRACTOR SHALL BE RESPONSIBLE FOR THE PROPER SELECTION AND COMPLETION OF THE WORK. THE CONTRACTOR SHALL BE RESPONSIBLE FOR THE COORDINATION OF THE WORK OF ALL TRADES.

NO.	DATE	ISSUANCE / REVISIONS
1	2024/03/20	ISSUED FOR PERMIT AND BID

SHEET TITLE
ENLARGED SITE PLAN AND DETAILS

SHEET NUMBER

A121

PROJECT: 25114 DATE: 2026/03/20 DRAWN: CAS

FILE: 25114_LEE MEMORIAL LIBRARY RV124