

**REINFORCED CONCRETE GENERAL NOTES**

- 1) ALL CONCRETE WORK SHALL CONFORM TO ACI 301, "SPECIFICATIONS FOR STRUCTURAL CONCRETE FOR BUILDINGS". DESIGN IS BASED ON ACI 318, "BUILDING CODE REQUIREMENTS FOR STRUCTURAL CONCRETE."
- 2) CONCRETE SHALL BE NORMAL WEIGHT (145 PCF) AND SHALL DEVELOP A MINIMUM COMPRESSIVE STRENGTH OF 4000 PSI AT 28 DAYS.
- 3) SUBMIT CONCRETE MIX DESIGNS FOR REVIEW, IN ACCORDANCE WITH ACI 318 TO THE ARCHITECT AND TESTING AGENCY.
- 4) THE PROPOSED MATERIALS AND MIX DESIGN SHALL BE FULLY DOCUMENTED AND REVIEWED. RESPONSIBILITY FOR OBTAINING THE REQUIRED DESIGN STRENGTH IS THE CONTRACTOR'S.
- 5) USE OF CALCIUM CHLORIDE, CHLORIDE IONS, OR OTHER SALTS IN CONCRETE IS NOT PERMITTED.
- 6) THE AIR CONTENT AT THE POINT OF PLACEMENT SHALL BE PER ACI 318 TABLE 19.3.2.1 FOR THE APPROPRIATE EXPOSURE CATEGORY. HARD-TROWELED SLABS OR SLABS ON GRADE THAT WILL RECEIVE TOPPING SHALL NOT RECEIVE AIR ENTRAINMENT UNLESS PERMITTED BY TOPPING MANUFACTURER.
- 7) THE TESTING AGENCY SHALL SAMPLE AND TEST EACH 100 CU. YARDS OR FRACTION THEREOF OF EACH CLASS OF CONCRETE PLACED EACH DAY. SAMPLE CONCRETE IN ACCORDANCE WITH ASTM C172. PERFORM THE FOLLOWING TESTS IN ACCORDANCE WITH THE INDICATED STANDARD:
  - SLUMP: ASTM C143
  - AIR CONTENT: ASTM C231 (NORMAL WEIGHT CONCRETE); ASTM C173 (LIGHT WEIGHT CONCRETE)
  - COMPRESSIVE STRENGTH: ASTM C39, WITH ONE CYLINDER AT 7 DAYS, TWO CYLINDERS AT 28 DAYS, AND ONE SPECIMEN HELD IN RESERVE.
  - CONCRETE TEMPERATURE: ASTM C1064
  - UNIT WEIGHT: ASTM C567
- 8) MOIST CURE CONCRETE WITH MOISTURE PROTECTIVE COVER FOR A MINIMUM OF 7 DAYS. CURING COMPOUNDS ARE PERMITTED IF COMPATIBLE WITH ANY PLANNED FLOOR FINISHES.
- 9) HORIZONTAL CONSTRUCTION JOINTS ARE PERMITTED ONLY WHERE INDICATED. THE LOCATION OF VERTICAL CONSTRUCTION JOINTS SHALL BE APPROVED BY THE ARCHITECT. CONSTRUCTION JOINTS SHALL BE THOROUGHLY ROUGHENED BY MECHANICAL MEANS, CLEANED, AND CAULKED.
- 10) REINFORCING STEEL SHALL CONFORM TO ASTM A615, GRADE 60, UNLESS NOTED OTHERWISE.
- 11) WELDED WIRE REINFORCING (W.W.R.) SHALL BE PLAIN WIRE CONFORMING TO ASTM A1064 AND SHALL BE PROVIDED IN FLAT SHEETS. LAP MESH AT LEAST ONE MESH SPACING AT SPLICES.
- 12) TIE ALL REINFORCING STEEL AND EMBEDMENTS SECURELY IN PLACE PRIOR TO PLACING CONCRETE. PROVIDE SUFFICIENT SUPPORTS TO MAINTAIN THE POSITION OF REINFORCEMENT WITHIN SPECIFIED TOLERANCES DURING ALL CONSTRUCTION ACTIVITIES. "STICKING" DOWELS INTO WET CONCRETE IS NOT PERMITTED.
- 13) REINFORCING STEEL SHALL HAVE THE FOLLOWING CONCRETE COVER UNLESS NOTED OTHERWISE:
  - CONCRETE CAST AGAINST EARTH (NOT FORMED): 3"
  - FORMED CONCRETE EXPOSED TO EARTH OR WEATHER: #6 BARS THROUGH #12 BARS 2"; #5 BARS AND SMALLER 1 1/2"
  - CONCRETE NOT EXPOSED TO EARTH OR WEATHER: SLABS AND WALLS 1"
- 14) TYPICAL FLOOR SLAB ON GRADE: 6" FIBER REINFORCED CONCRETE ON 10MIL. VAPOR BARRIER & 4" GRAVEL.
- 15) DO NOT WELD OR TACK WELD REINFORCING STEEL UNLESS APPROVED OR DIRECTED BY THE STRUCTURAL ENGINEER.

**SOIL PARAMETERS**

- 1) FOOTINGS ARE DESIGNED FOR A MINIMUM ALLOWABLE SOIL BEARING PRESSURE OF 2500 POUNDS PER SQUARE FOOT. CONTRACTOR SHALL PROVIDE SOIL TESTING TO CONFIRM SOIL BEARING PRESSURE. RESULTS SHALL BE SUBMITTED TO CITY OF DUBLIN.
- 2) IF SITE CONDITIONS DIFFER FROM THOSE INDICATED, THE DESIGN PROFESSIONAL SHALL BE NOTIFIED IMMEDIATELY.
- 3) ALL FOUNDATION WORK SHALL BE DONE "IN THE DRY".

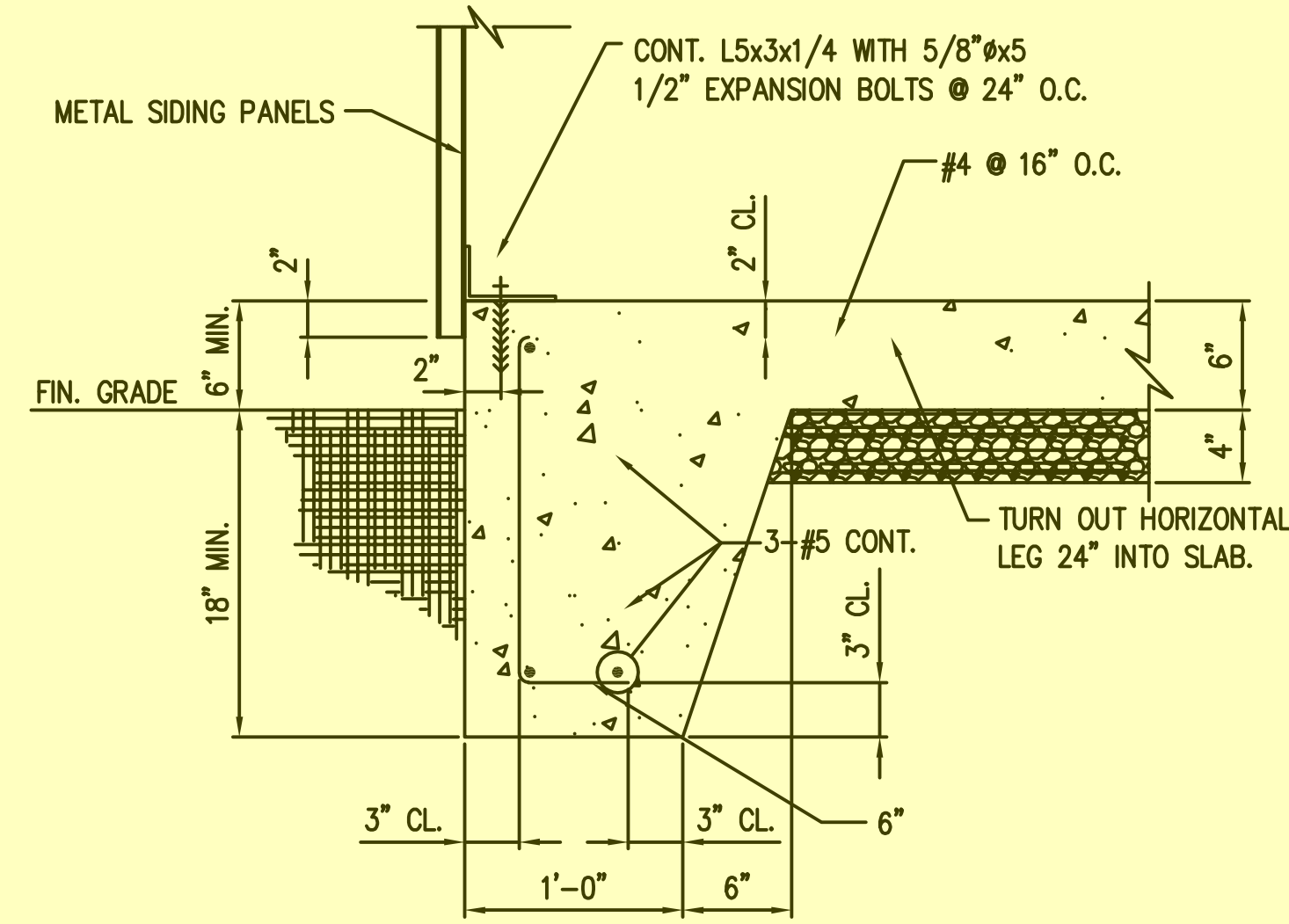

**TYPICAL EDGE OF SLAB TURNDOWN**  
SCALE: N.T.S.

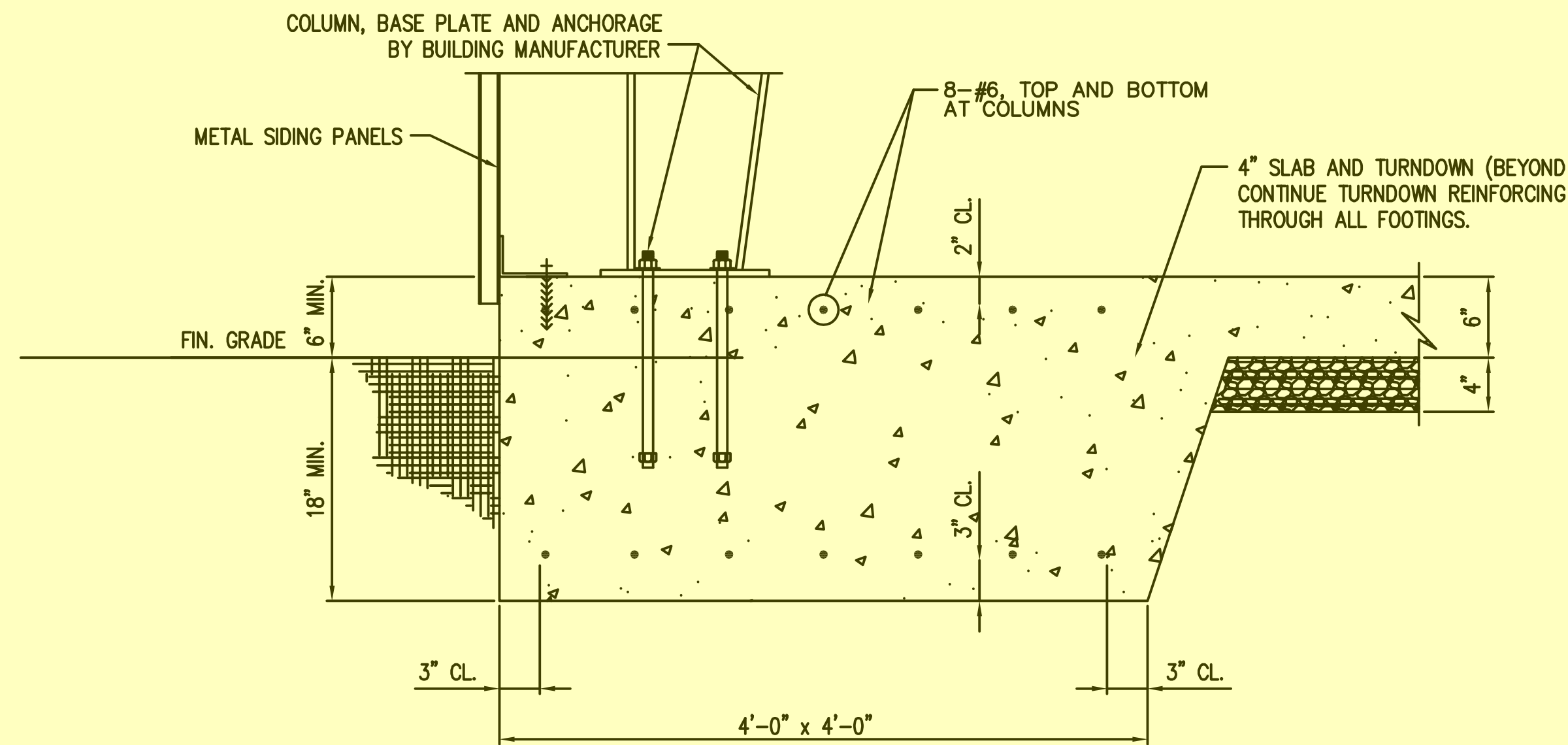

**TYPICAL COLUMN FOOTING**  
SCALE: N.T.S.

**EXISTING WATER WELL SLAB DETAILS & NOTES**

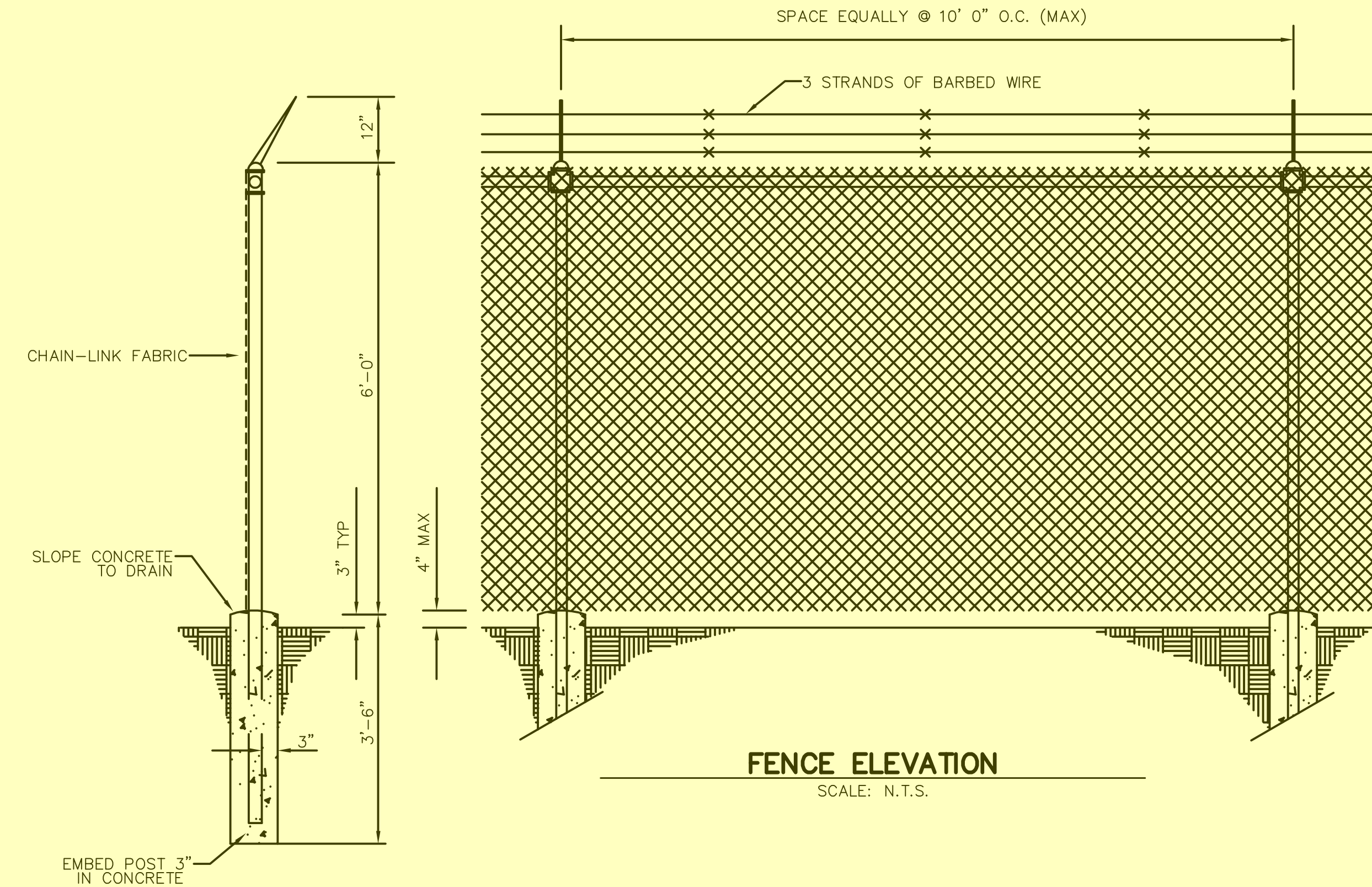

**FENCE ELEVATION**  
SCALE: N.T.S.

**3 STRAND BARBED WIRE FENCE DETAIL & NOTES**

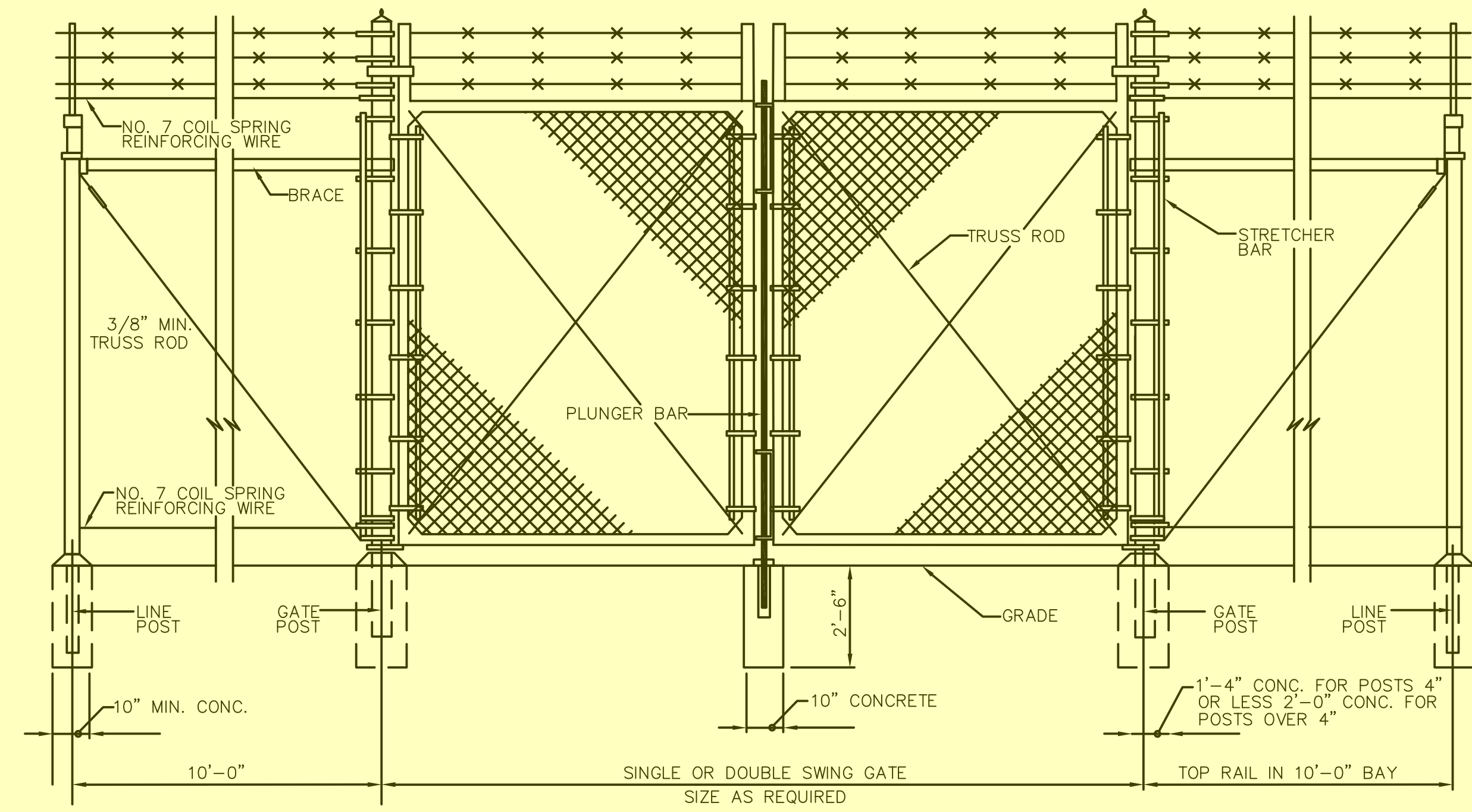

**GATE ELEVATION**  
SCALE: N.T.S.

DATE	REVISION	ITEM

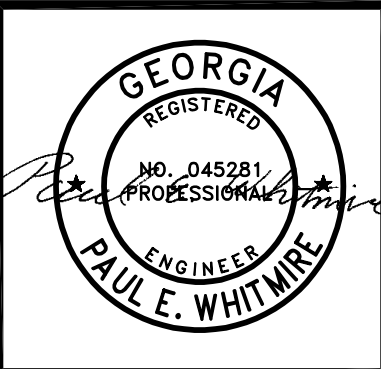

STRUCTURAL DETAILS  
SHEET:

590 MEANS STREET NW  
STE. 200  
ATLANTA, GA 30318  
**TOLAND MIZELL MOLNAR**

**FIXED AND PORTABLE GENERATOR INSTALLATIONS**

JOB NO: TMM 2507  
DATE: 02-06-26  
DRAWN: FSD  
CHECKED: PEW  
APPROVED: RBP  
SCALE: AS NOTED

SHEET  
**50**