

| | |
|--------------|------------------------|
| JOB NO.: | 02502 |
| DRAWN BY: | AM |
| CHECKED BY: | JM |
| DESCRIPTION: | ISSUE FOR CONSTRUCTION |
| DATE: | 12.17.25 |
| DESCRIPTION: | |
| DATE: | |
| DESCRIPTION: | |
| DATE: | |
| REVISIONS: | |
| 1 | 03.13.26 |
| 2 | |
| 3 | |
| 4 | |
| 5 | |
| 6 | |
| 7 | |

THESE DRAWINGS ARE THE PROPERTY OF GM ARCHITECT AND ARE NOT TO BE REPRODUCED OR REUSED WITHOUT PERMISSION AND CREDIT. COPYRIGHT: © 2025

SHEET

KEYED NOTES:

- 1 COORDINATE EXACT LOCATION OF POWER COMPANY TRANSFORMER AND EMERGENCY GENERATOR WITH POWER COMPANY, ARCHITECT AND CIVIL ENGINEER.
- 2 PROVIDE 2-3" C. FOR TELEPHONE AND DATA SERVICE. PROVIDE HAND-HOLES AS REQUIRED BY 2023 NEC IN GRASS AREA. COORDINATE STUB-OUT LOCATION AT PROPERTY LINE WITH SERVICE PROVIDERS.
- 3 STUB UP UNDER TEL BOARD. SEE 5/E4.1.
- 4 COORDINATE EXACT LOCATION OF SIGN, CONNECTIONS AND POWER REQUIREMENTS PRIOR TO ANY WORK. ADJUST BRANCH CIRCUITRY PER 2023 NEC.
- 5 PROVIDE 30A/3P/3R DISCONNECT FOR SIGN. CONTROL OF SIGN PROVIDED WITH UNIT. PROVIDE 3#8, #10G, 3/4" C TO CIRCUIT INDICATED. SEE KEYED NOTE 6.
- 6 ROUTE A 1 IN. C. FROM SIGN TO MAIN ELECTRICAL ROOM FOR CONTROLS.
- 7 P.E CELL MOUNTED FACING NORTH. CLEAR OF MAN MADE LIGHT SOURCES. J-BOX TO HOUSE P.E. CELL SHALL BE RECESSED MOUNTED WITH STAINLESS STEEL GASKETED COVER.
- 8 ROUTE VIA 10 POLE EXTERIOR LIGHTING CONTACTOR/TIMELOCK LOCATED IN ELECTRICAL ROOM. PHOTO CELL SHALL CONTROL DUSK TILL DAWN OPERATION. TIMELOCK SHALL BE 365 DAY DIGITAL PROGRAMMABLE TYPE WITH 30A RATED CONTACTS. SEE KEYED NOTE 6 ON SHEET E2.1. PROVIDE OVERRIDE SWITCH ADJACENT TIMELOCK.
- 9 PROVIDE 3#10, 3/4" C THROUGHOUT BRANCH CIRCUIT.
- 10 SEE POLE BASE DETAIL 2/E1.1.

GENERAL NOTES:

- A. SURVEY AND SITE INFORMATION PROVIDED BY OTHERS. VERIFY ALL CONDITIONS ON SITE AND WITH OFFICIAL SURVEYS AND OTHER TRADES.
- B. CALL UNDERGROUND UTILITY CENTER AND VERIFY ALL UNDERGROUND UTILITIES.
- C. UNDERGROUND CONDUIT SHALL BE SCHEDULE 40 PVC.
- D. COORDINATE WITH SERVING UTILITY COMPANIES FOR EXACT SERVICE LOCATIONS. CONTRACTOR SHALL PAY ALL ADDITIONAL COSTS TO PROVIDE SERVICES SHOWN.
- E. PROVIDE HAND-HOLES AS REQUIRED BY 2023 NEC FOR UNDERGROUND FEEDERS SHOWN.

GENERAL NOTES - LOCATION OF UTILITY COMPANY PAD MOUNTED TRANSFORMER:

TRANSFORMER PAD LOCATIONS SHALL BE A MINIMUM OF 10 FT.-0 IN. FROM ANY BUILDING OVERHANGS, CANOPIES, EXTERIOR WALLS, BALCONY, EXTERIOR STAIRS AND OR WALKWAYS CONNECTED TO THE BUILDING.

TRANSFORMER PAD EDGE SHALL BE NO LESS THAN 14 FT.-0 IN. FROM ANY DOOR WAY.

TRANSFORMER PAD EDGE SHALL BE NO LESS THAN 10 FT.-0 IN. FROM ANY WINDOWS OR OTHER OPENINGS.

IF THE BUILDING HAS AN OVERHANG THE 10 FT.-0 IN. CLEARANCE SHALL BE MEASURED FROM A POINT BELOW THE EDGE OF THE OVERHANG ONLY IF THE BUILDING IS 3 STORIES OR LESS. IF THE BUILDING IS 4 STORIES OR MORE 10 FT.-0 IN. SHALL BE MEASURED FROM THE OUTSIDE BUILDING WALL.

FIRE ESCAPES, OUTSIDE STAIRS, AND COVERED WALKWAYS ATTACHED TO OR BETWEEN BUILDINGS, SHALL BE CONSIDERED PART OF THE BUILDING.

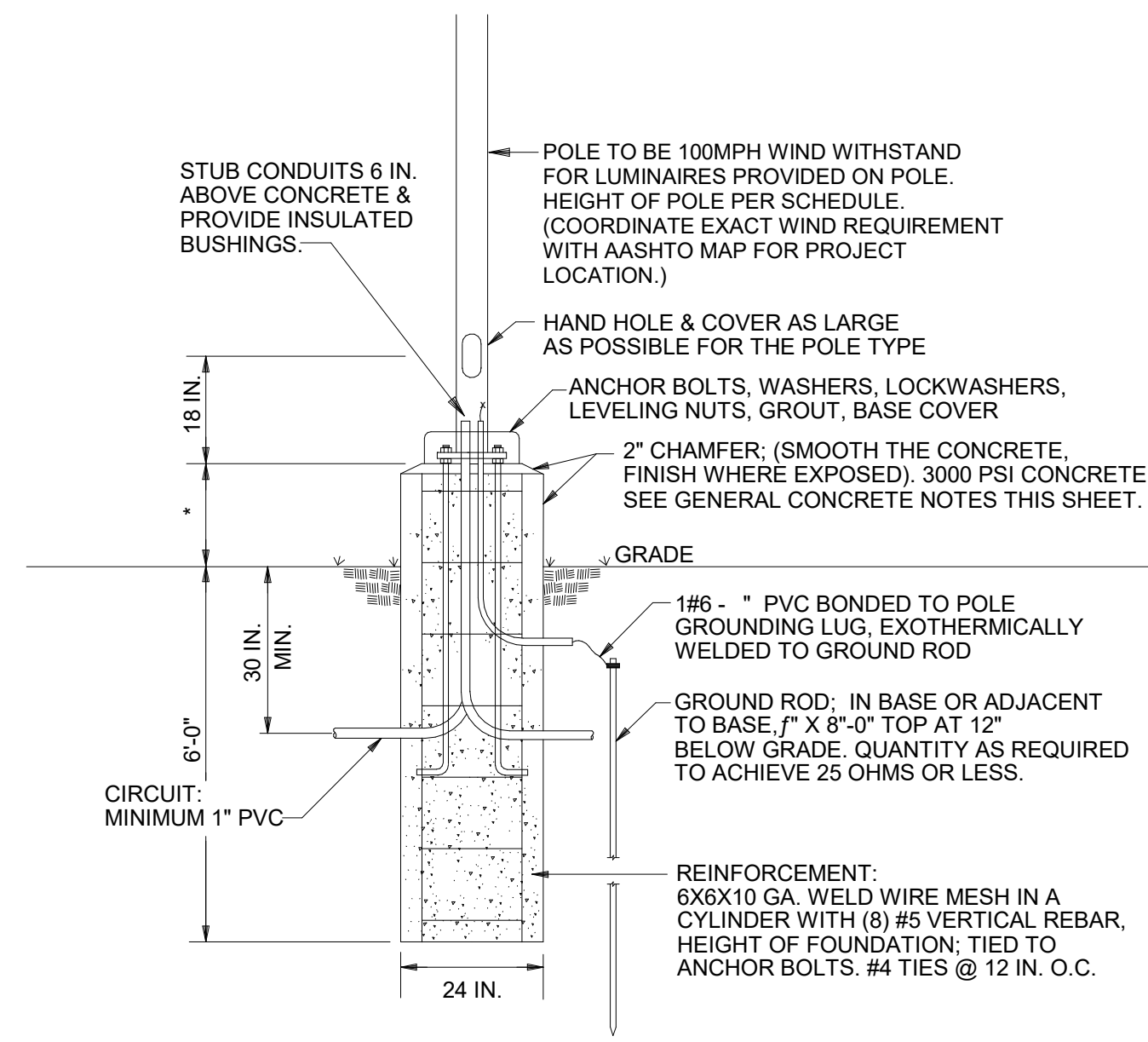

* EXPOSED FOUNDATION:
WITHIN PARKING LOT = 36 IN. POLE BASE HEIGHT
GRASSED AREAS = 12 IN. POLE BASE HEIGHT

2 DETAIL - POLE BASE DETAIL
E1.1 NO SCALE

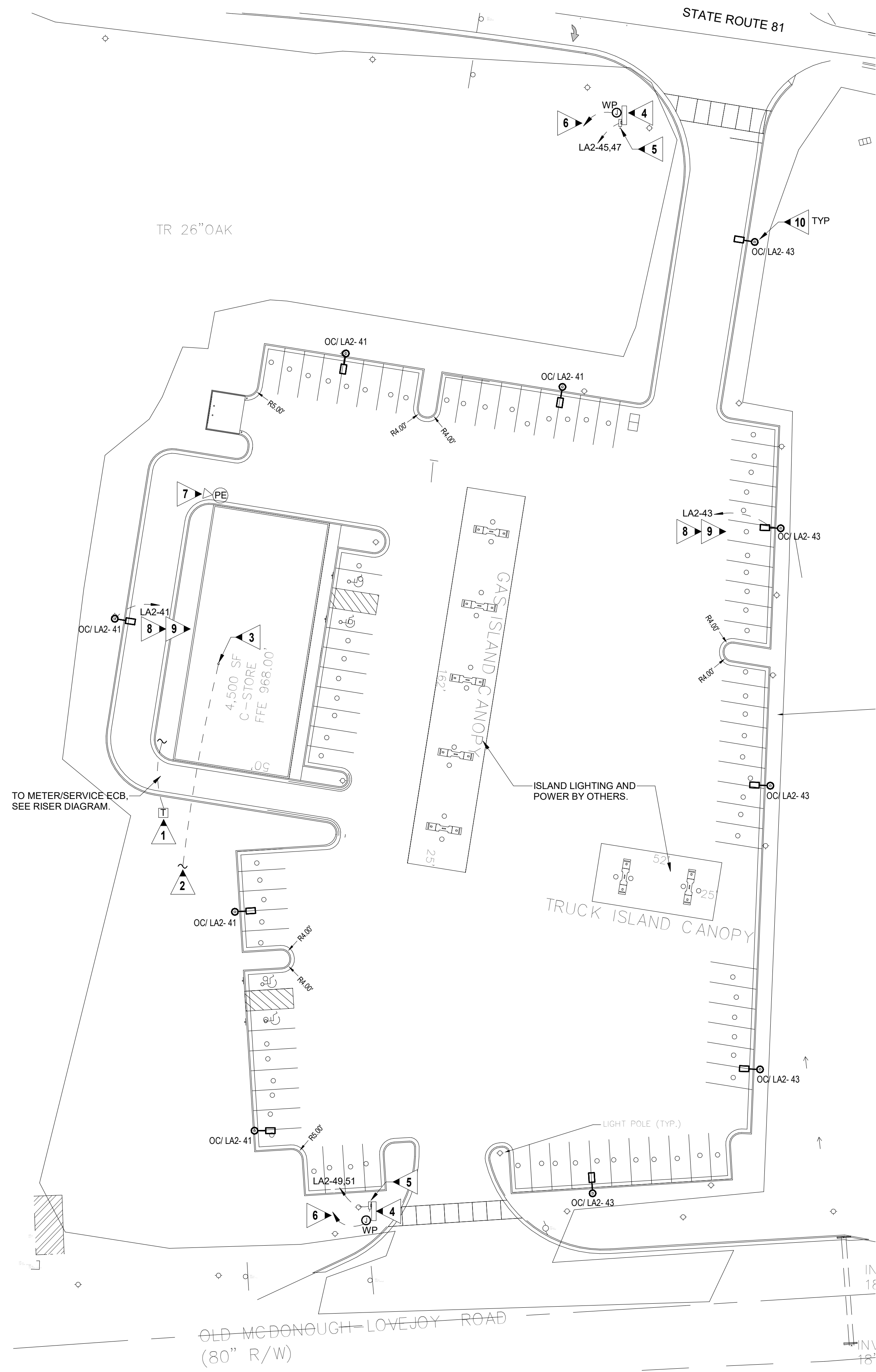

1 SITE PLAN - ELECTRICAL
E1.1 SCALE: 1" = 30'-0"