

CAUTION

CONTRACTOR SHALL BE RESPONSIBLE FOR SECURING THE SERVICES OF A PRIVATE UTILITY LOCATOR FIRM DURING THE ENTIRE COURSE OF CONSTRUCTION. CONTRACTOR SHALL PAY FOR SAID SERVICES. CONTRACTOR SHALL REPAIR ALL UTILITIES DAMAGED BY CONSTRUCTION ACTIVITIES, AT NO ADDITIONAL COST TO THE OWNER/DEVELOPER.

THE UTILITIES SHOWN ARE SHOWN FOR THE CONTRACTOR'S CONVENIENCE ONLY. THERE MAY BE OTHER UTILITIES NOT SHOWN ON THESE PLANS. THE SITE DESIGN PROFESSIONAL ASSUMES NO RESPONSIBILITY FOR THE LOCATIONS SHOWN AND IT SHALL BE THE CONTRACTOR'S RESPONSIBILITY TO VERIFY THE LOCATIONS OF UTILITIES WITHIN THE LIMITS OF THE WORK. DAMAGE TO EXISTING UTILITIES BY THE CONTRACTOR, FROM HIS/HER OPERATIONS SHALL BE THE SOLE RESPONSIBILITY OF THE CONTRACTOR.

CONTRACTOR SHALL BE RESPONSIBLE FOR COMPACTION OF BACKFILL OF ALL UTILITY TRENCHES WITHIN SITE WORK LIMITS. THIS INCLUDES TRENCHES DUG AND BACKFILLED BY LOCAL UTILITIES SUCH AS POWER, GAS, TELEPHONE, ETC. CONTRACTOR SHALL PROVIDE ADDITIONAL BACKFILL AND COMPACTION AS NECESSARY, IF SETTLEMENT OCCURS.

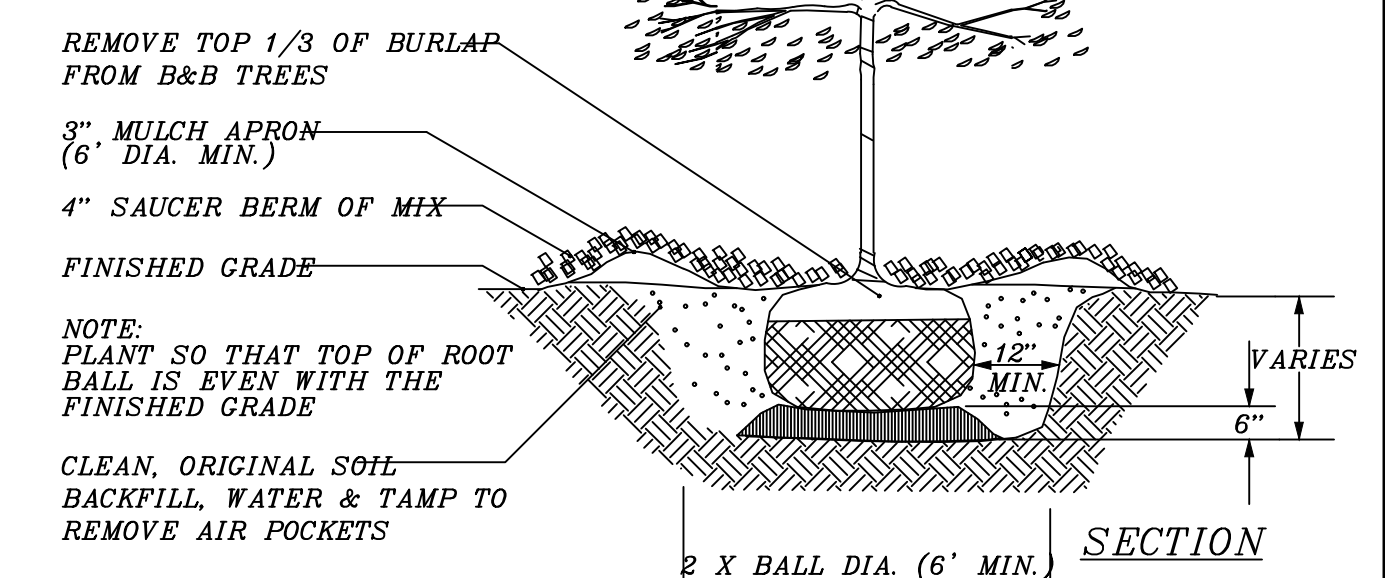
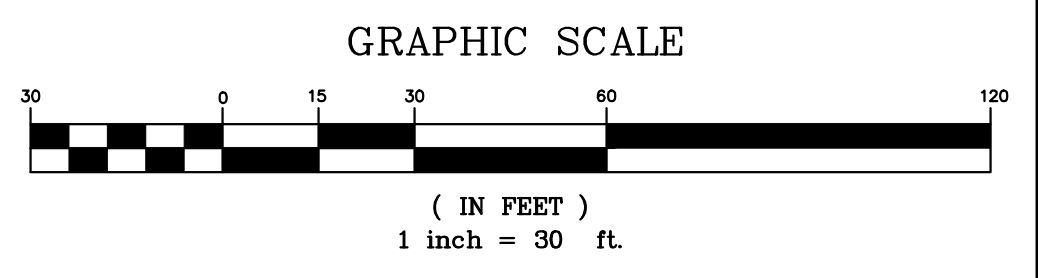
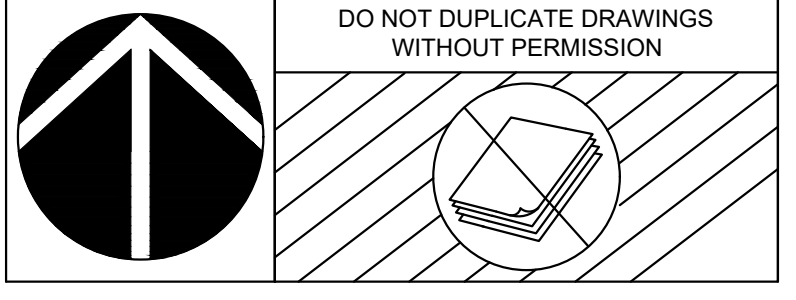

1
L-1

PLANT LIST

QUANTITY	COMMON NAME	SIZE	HEIGHT	CONDITION
TREES				
9	JAPANESE MAPLE	3" CAL	6'	B&B
4	STAR MAGNOLIA	3" CAL	6'	B&B
11	AMUR MAPLE	3" CAL	6'	B&B
6	CRABAPPLE	3" CAL	6'	B&B
15	NORTHERN RED OAK	3" CAL	6'	B&B

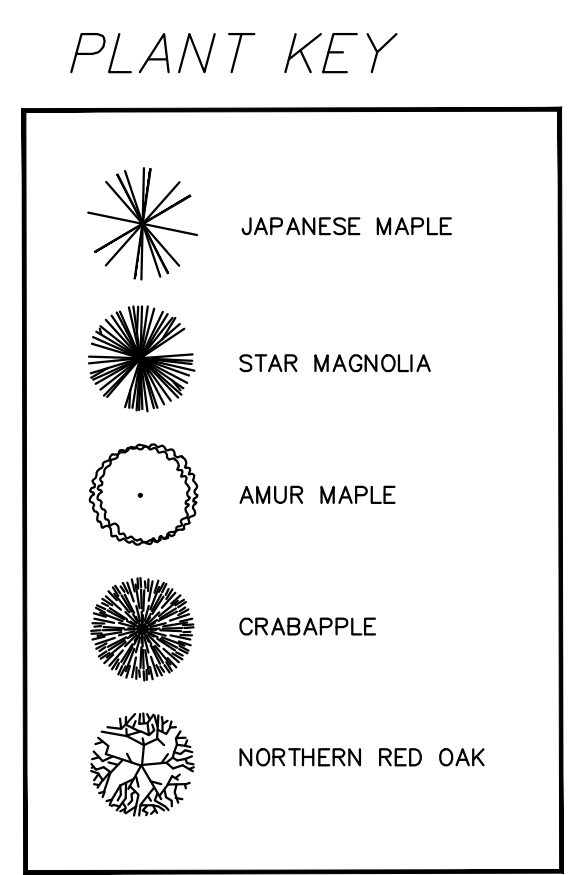

REQUIRED VS. PROPOSED

REQUIRED	PROPOSED
FRONT: 1 TREE PER 40 L.F. FRONTAGE X 734 L.F. = ~19 TREES	~18 TREES PER 0.057AC X 0.54C TREE PRESERVATION AREA = ~158 TREES
SIDE: 1 TREE PER 25 L.F. FRONTAGE X 957 L.F. = ~39 TREES	7 NEW TREES
TOTAL = 58 TREES	TOTAL = ~165 TREES PROVIDED

MOORE CIVIL
CONSULT T-DESIGN-ENGINEER
ROBERT@MOORECIVIL.COM
706.224.1629

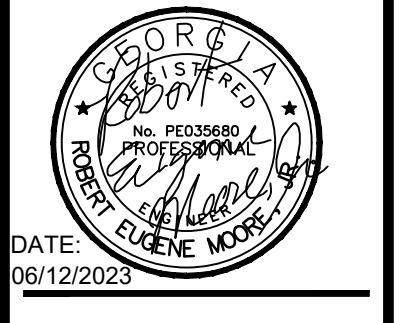

DATE: 06/12/2023

This document, together with the concepts and designs presented herein, as an instrument of services, is intended only for the specific purpose and client for which it was prepared. Reuse of and improper reliance on this document without written authorization by Moore Civil Consulting, Inc. shall be without liability to Moore Civil Consulting, Inc. Copyright Moore Civil Consulting, Inc. 2018

24 HOUR CONTACT
MEHULKUMAR GAJJAR
404-483-2157

CLIENT:
HANSA PATEL
908 DONAGAL DR
LOCUST GROVE, GA, 30248
404-483-2157

OWNER INFORMATION:
HANSA PATEL
908 DONAGAL DR
LOCUST GROVE, GA, 30248
404-483-2157

REVISIONS:

DATE	DESCRIPTION
6/21/22	GRADING PLAN
10/21/22	1st LDP SUBMITTAL
10/21/22	1st GDOT SUBMITTAL
01/30/2023	NEW LAYOUT
02/21/2023	NEW LAYOUT
05/09/2023	2nd LDP SUBMITTAL
05/09/2023	2nd GDOT SUBMITTAL
12/19/2023	3rd GDOT SUBMITTAL
12/19/2023	3rd LDP SUBMITTAL
03/05/2023	4rd LDP SUBMITTAL
03/05/2023	3rd GDOT SUBMITTAL
04/24/2024	6TH GDOT SUBMITTAL
05/21/2024	7TH GDOT SUBMITTAL
12/12/2024	8TH GDOT SUBMITTAL
03/06/2025	5TH LDP SUBMITTAL
07/03/2025	6TH LDP SUBMITTAL

HWY 81 C-STORE
HWY 81
HAMPTON, GA 30228

SHEET TITLE:
LANDSCAPING PLAN

SHEET NUMBER:
L.100