

**PARTITION TYPES**

**WOOD FRAMING PARTITIONS**

- 6.4.1 2x4 WOOD STUDS AT 16" O. C. WITH 1 LAYER 5/8" TYPE "X" GYPSUM BOARD ON ROOM SIDE FACE ONLY WITH SOUND ATTENUATION INSULATION.
- 6.4.2 2x4 WOOD STUDS AT 16" O. C. WITH 1 LAYER 5/8" TYPE "X" GYPSUM BOARD ON BOTH FACES & SOUND ATTENUATION INSULATION.
- 6.4.3 2x4 WOOD STUDS AT 16" O. C. WITH 1 LAYER 5/8" TYPE "X" GYPSUM BOARD ON ROOM SIDE FACE ONLY & SOUND ATTENUATION INSULATION.
- 6.4.4 2x4 WOOD STUDS AT 16" O. C. WITH 1 LAYER 5/8" TYPE "X" GYPSUM BOARD ON EACH FACE. (UL DESIGN NO. U305) & SOUND ATTENUATION INSULATION.
- 6.4.5 2x4 WOOD STUDS AT 16" O. C. WITH 2 LAYER 5/8" TYPE "X" GYPSUM BOARD ON EACH FACE W/ THERMAL INSULATION R13. (UL DESIGN NO. U305)
- 6.6.1 2x6 WOOD STUDS AT 16" O. C. WITH 1 LAYER 5/8" TYPE "X" GYPSUM BOARD ON ROOM SIDE FACE ONLY WITH SOUND ATTENUATION INSULATION.
- 6.6.2 2x6 WOOD STUDS AT 16" O. C. WITH 1 LAYER 5/8" TYPE "X" GYPSUM BOARD ON BOTH FACES & SOUND ATTENUATION INSULATION.
- 6.6.3 2x6 WOOD STUDS AT 16" O. C. WITH 1 LAYER 5/8" TYPE "X" GYPSUM BOARD ON ROOM SIDE FACE ONLY & SOUND ATTENUATION INSULATION.
- 6.6.4 2x6 WOOD STUDS AT 16" O. C. WITH 1 LAYER 5/8" TYPE "X" GYPSUM BOARD ON BOTH SIDES. (UL DESIGN NO. U305) & SOUND ATTENUATION INSULATION.
- 6.6.5 2x6 WOOD STUDS AT 16" O. C. WITH 2 LAYER 5/8" TYPE "X" GYPSUM BOARD ON EACH FACE W/ THERMAL INSULATION R19. (UL DESIGN NO. U305)

**GENERAL PARTITIONS NOTES:**

- (1) ALL PARTITIONS TO TERMINATE AT BOTTOM OF CEILING JOIST OR AT BOTTOM OF ROOF SHEATHING U. O. N.
- (2) ALL FIRE RATED WALLS & PARTITIONS TO TERMINATE AT BOTTOM OF FLOOR / CEILING JOISTS AND BOTTOM OF ROOF SHEATHING. FLOOR TO THE UNDERSIDE OF THE ROOF OR FIRE RATED FLOOR DECK WITH ALL OPENINGS SEALED TIGHT.
- (3) RATED WALL CONSTRUCTION THAT EXTENDS FROM THE FLOOR TO THE UNDERSIDE OF FLOOR / CEILING JOISTS OR ROOF SHEATHING SHALL BE FIRE-SEALED TIGHT.
- (4) FIRE STOP SYSTEMS AND DEVICES: PENETRATIONS FOR CABLES, CABLE TRAYS, CONDUITS, PIPES, TUBES, COMBUSTION VENTS AND EXHAUST VENTS, WIRES, AND SIMILAR ITEMS TO ACCOMMODATE ELECTRICAL, MECHANICAL, PLUMBING, AND COMMUNICATIONS SYSTEMS THAT PASS INTO OR THROUGH A WALL, FLOOR, OR FLOOR/CEILING ASSEMBLY CONSTRUCTED AS A FIRE BARRIER SHALL BE PROTECTED BY A FIRE STOP SYSTEM OR DEVICE. LIFE SAFETY CODE SECTION 8.3.5.1 OF THE 2018 EDITION. FIRE STOP SYSTEMS SHALL HAVE A MINIMUM OF ONE (1) HOUR F RATING, BUT NOT LESS THAN THE REQUIRED FIRE RESISTIVE RATING OF THE FIRE BARRIER PENETRATED. SECTION 8.3.5.1.3. PENETRATIONS IN FIRE RATED HORIZONTAL ASSEMBLIES SHALL HAVE A MINIMUM OF ONE (1) HOUR F RATING, BUT NOT LESS THAN THE FIRE RESISTIVE RATING OF THE HORIZONTAL ASSEMBLY. SECTION 8.3.5.1.4. SEE MECHANICAL AND ELECTRICAL DRAWINGS FOR DETAILS.
- (5) IDENTIFICATION OF FIRE BARRIERS SHALL BE BY SIGNS OR STENCILING PERMANENTLY INSTALLED ON ALL RATED BARRIERS OR WALLS, ABOVE ANY DECORATIVE CEILING AND/OR IN CONCEALED SPACES. THE LETTERING SHALL BE 2" IN HEIGHT AND SPACED EVERY 12 FEET. THE FOLLOWING WORDING IS RECOMMENDED: "ONE (1) OR TWO(2) HOUR FIRE AND SMOKE BARRIER PROTECT ALL OPENINGS."

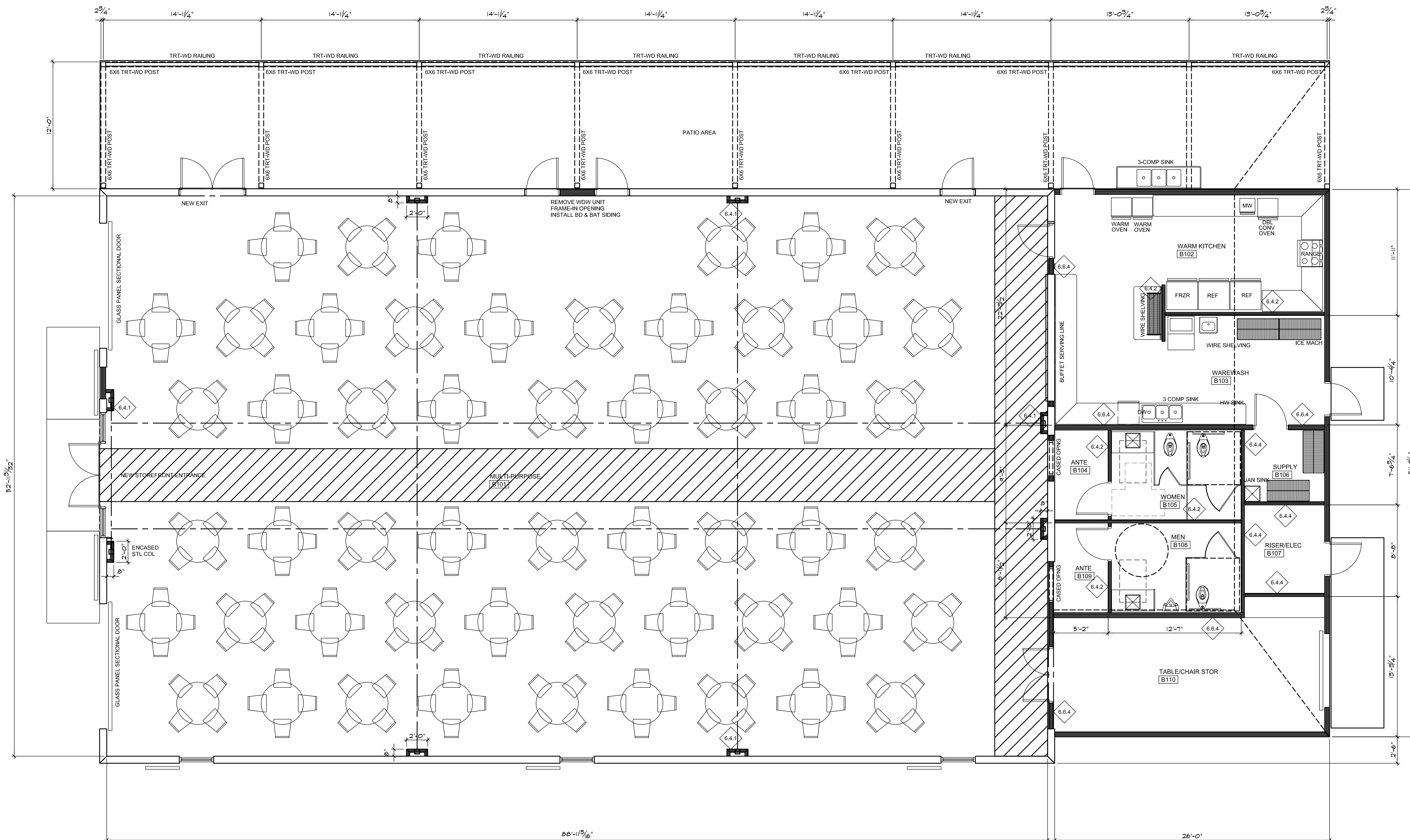

PROJ NORTH

**FLOOR PLAN: THE ACTIVITY BARN - PHASE 2**

SCALE: 1/4" = 1'-0"

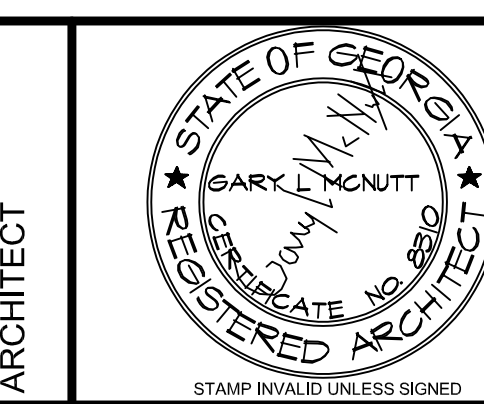

960 Sutton Road  
FORSYTH, GEORGIA 31029  
gary@gmarchitectllc.net  
(478)-365-8976

ARCHITECT  
CONSULTANT

STAMP INVALID UNLESS SIGNED

**SUNBELT**  
BUILDERS

10641 HIGHWAY 36  
COVINGTON, GA 30014  
770.786.3031

**Retrofit & Renovations for  
Madison Methodist Church  
Phase 2: Activity Barn**  
Madison, Georgia 30650  
1091 Confederate Highway

JOB NO.:	02801
DRAWN BY:	GM
CHECKED BY:	GM
DESCRIPTION:	SCM-REVIEW-P2
DATE:	12-15-26
DESCRIPTION:	DD-REVIEW
DATE:	00-00-26
DESCRIPTION:	CD-REVIEW
DATE:	03-12-26
DESCRIPTION:	BID-CONSTRUCTION
DATE:	00-00-26
REVISIONS:	
1	00-00-26
2	
3	
4	
5	
6	
7	

THESE DRAWINGS ARE THE PROPERTY OF GM ARCHITECT AND ARE NOT TO BE REPRODUCED OR HELD WITHOUT PERMISSION AND CREDIT.  
COPYRIGHT: (C) 2026

SHEET  
**A1.1**

OF