

WINDOW SCHEDULE

ABBREVIATIONS:		WINDOW UNIT										TRIM & SILL			DETAILS							
AL	ALUMINUM	NR	NOT RATED(NO RATING)	WD	WOOD																	
FF	FACTORY FINISH	PT	PAINT																			
GL1	GLAZING TYPE	SF	STOREFRONT SYSTEM																			
HLB	HORIZONTAL LOUVER BLIND	SS	SOLID SURFACE MATERIAL																			
HM	HOLLOW METAL	STL	STEEL																			
NA	NOT APPLICABLE																					
SYMBOL	R. O. SIZE	UNIT SIZE			TYPE			MATERIAL			FINISH			SHEET A8.3 U.O.N.					FIRE RATING	WDW TRMT	REMARKS	
SPACE	MARK	W	H	W	H	D	TYPE	MATL.	FIN	GL.	TYPE	MATL.	FIN	TYPE	MATL.	FIN	H	J	S	FIRE RATING	WDW TRMT	REMARKS
DETAILS ON SHEET A8.3.2																						
B101	B101A	3'-3" +/-	6'-0" +/-	3'-2"	5'-11" +/-	4 1/2"	A	AL	FF	GL2	N/A	N/A	N/A	-	WD	FF	?	?	?	N/A	N/A	FIELD VERIFY R O SIZE
B101	B101B	5'-6" +/-	4'-6" +/-	5'-4" +/-	4'-4" +/-	4 1/2"	B	AL	FF	GL1	N/A	N/A	N/A	-	WD	PT	?	?	?	N/A	N/A	FIELD VERIFY R O SIZE

GLASS TYPES

GL 1	INSULATING GLASS WITH TINTED LOW-E EXTERIOR PANE AND CLEAR GLASS INTERIOR PANE.
GL 2	INSULATING GLASS WITH TEMPERED TINTED LOW-E EXTERIOR PANE AND TEMPERED CLEAR GLASS INTERIOR PANE.
GL 3	INSULATING GLASS WITH TINTED EXTERIOR PANE AND CLEAR GLASS INTERIOR PANE.
GL 4	INSULATING GLASS WITH TEMPERED TINTED EXTERIOR PANE AND TEMPERED CLEAR GLASS INTERIOR PANE.
GL 5	SINGLE 1/4" TINTED GLASS.
GL 6	SINGLE 1/4" CLEAR GLASS.
GL 7	SINGLE 1/4" TEMPERED CLEAR GLASS.
GL 8	SOUND INSULATING GLASS WITH CLEAR LAMINATED PLATE GLASS PANELS BOTH PANES.
GL 9	SINGLE TEMPERED TINTED GLASS.
GL 10	INSULATING GLASS WITH CLEAR EXTERIOR PANE AND CLEAR GLASS INTERIOR PANE.
GL 11	INSULATING GLASS WITH TEMPERED CLEAR EXTERIOR PANE AND TEMPERED CLEAR GLASS INTERIOR PANE.
GL 12	1/4" WIRE GLASS.

DOOR AND FRAME SCHEDULE

ABBREVIATIONS:		DOOR										FRAME			HDWE.				
AL	ALUMINUM	SCW	SOLID CORE WOOD	WD	WOOD														
GL	GLASS TYPE	STN	STAIN	WPL	WOOD PANEL														
HCW	HOLLOW CORE WOOD	STL	STEEL																
HR	HOOR RATING	S. S.	STAINLESS STEEL																
SYMBOL	OPENING SIZE	DOOR			FRAME			DETAILS					FIRE RATG	HDWE. GRP.	KEY SPACE	REMARKS			
SPACE	MARK	W	H	T	MATL.	TYPE	GL.	UND. CUT.	MATL.	DEPTH	TYPE	TRIM TYPE	H	J	S	FIRE RATG	HDWE. GRP.	KEY SPACE	REMARKS

ACTIVITY BARN

B101	B101A	6'-0"	7'-0"	1'-3/4"	AL	BA	GL7	1/2"	AL	4-1/2"	BA	N/A	?	?	?	N/A	?	EXT	-
B101	B101B	12'-0"	12'-0"	1'-3/4"	AL	BB	GL11	-	STL	1'-3/4"	BB	N/A	?	?	?	N/A	?	EXT	GLASS SECTIONAL DOOR
B101	B101C	12'-0"	12'-0"	1'-3/4"	AL	BB	GL11	-	STL	1'-3/4"	BB	N/A	?	?	?	N/A	?	EXT	GLASS SECTIONAL DOOR
B101	B101D	6'-0"	7'-0"	1'-3/4"	HM	BDD	-	1/2"	STL	7-3/4"	BDD	N/A	?	?	?	N/A	?	EXT	-
B101	B101E	3'-0"	7'-0"	1'-3/4"	HM	BD	-	1/2"	STL	7-3/4"	BD	N/A	?	?	?	N/A	?	EXT	-
B101	B101F	3'-0"	7'-0"	1'-3/4"	HM	BD	-	1/2"	STL	7-3/4"	BD	N/A	?	?	?	N/A	?	EXT	-
B101	B101G	3'-0"	7'-0"	1'-3/4"	HM	BD	-	1/2"	STL	7-3/4"	BD	N/A	?	?	?	N/A	?	EXT	-
B102	B102A	3'-0"	7'-0"	1'-3/4"	HM	BD	-	1/2"	STL	7-3/4"	BD	N/A	?	?	?	N/A	?	EXT	-
B102	B102B	3'-0"	7'-0"	1'-3/4"	SCW	BE	N/A	3/4"	STL	5-3/4"	BE	N/A	?	?	?	34 HR	?	EXT	-
B103	B103A	3'-0"	7'-0"	1'-3/4"	HM	BD	-	1/2"	STL	7-3/4"	BD	N/A	?	?	?	N/A	?	EXT	-
B103	B103B	12'-0"	3'-6"	2"	STL	BG	GL7	-	STL	2"	BG	N/A	?	?	?	34 HR	?	101B	-
B104	B104	3'-0"	7'-0"	-	-	-	-	-	STL	7-3/4"	BF	-	-	-	-	-	-	-	FRAME ONLY
B105	B105	3'-0"	7'-0"	1'-3/4"	SCW	BE	N/A	3/4"	STL	5-3/4"	BE	N/A	?	?	?	-	?	-	-
B106	B106	3'-0"	7'-0"	1'-3/4"	SCW	BE	N/A	3/4"	STL	5-3/4"	BE	N/A	?	?	?	34 HR	?	B103	-
B107	B107	3'-0"	7'-0"	1'-3/4"	HM	BD	-	1/2"	STL	7-3/4"	BD	N/A	?	?	?	N/A	?	EXT	-
B108	B108	3'-0"	7'-0"	1'-3/4"	SCW	BE	N/A	3/4"	STL	5-3/4"	BE	N/A	?	?	?	-	?	-	-
B109	B109	3'-0"	7'-0"	-	-	-	-	-	STL	7-3/4"	BF	-	-	-	-	-	-	-	FRAME ONLY
B110	B110A	8'-0"	8'-0"	2"	STL	BC	-	-	STL	2"	BC	N/A	?	?	?	-	?	EXT	SECTIONAL OVERHEAD DOOR
B110	B110B	6'-0"	7'-0"	1'-3/4"	SCW	BEE	N/A	3/4"	STL	5-3/4"	BEE	N/A	?	?	?	34 HR	?	B101	-

DOOR, WINDOW, AND FRAME NOTES

- ALL STEEL DOORS, WINDOWS, AND FRAMES SHALL BE PAINTED INCLUDING ALL TOPS, BOTTOMS, AND EDGES.
- ALL WOOD DOORS, WINDOWS, AND FRAMES SHALL BE PAINTED OR STAINED INCLUDING ALL TOPS, BOTTOMS, AND EDGES.

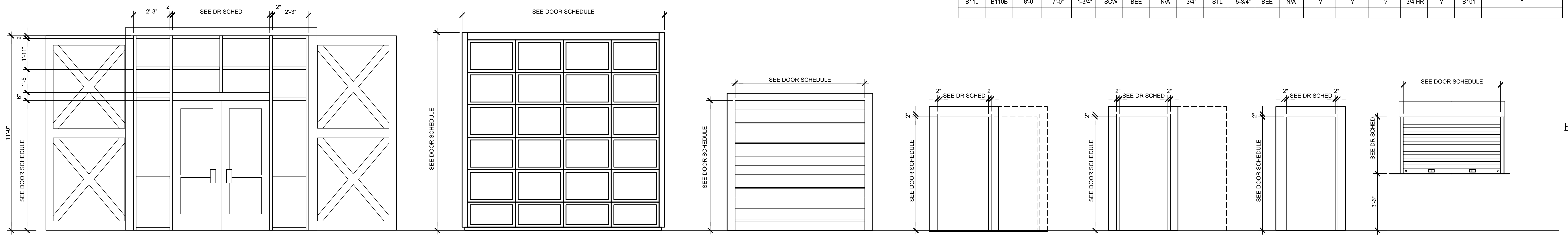

BA
KAWNEER TRIFAB 451T STOREFRONT SYSTEM
CAPTIONED 4 SIDES
KAWNEER 550 STANDARD ENTRANCE DOOR

BB
SECTIONAL OVERHEAD DOOR: ALUMINUM GLASS MODEL 511 BY
OVERHEAD DOOR CORPORATION. 1-3/4" PANEL THICKNESS, ELECTRIC
OPERATION, INTERIOR MOUNTED, POWDER COATED FINISH (WHITE)

BC
SECTIONAL OVERHEAD DOOR: 420 SERIES STEEL
DOOR BY OVERHEAD DOOR CORPORATION.
2" PANEL THICKNESS, INSULATED, RIBBED, 20 GAUGE GAL
STEEL, CHAIN HOIST OPERATION, INTERIOR MOUNTED,
KEYED LOCK, TWO COAT BAKE-ON POLYESTER FINISH (WHITE).

BD **BDD**
EXT. FRAMES: FULL PROFILE WELDED,
LEVEL 1, 0.042 INCH STL SHEET
EXT. DOORS: LEVEL 1, PP LEVEL C, MODEL 1

BE **BEE**
INT. FRAMES: FULL PROFILE WELDED,
LEVEL 1, 0.042 INCH STL SHEET
INT. DOORS: SOLID-CORE WOOD, PANEL
WDMA 1.5.1-A, HEAVY DUTY

BF
INT. FRAMES: FULL PROFILE WELDED,
LEVEL 1, 0.042 INCH STL SHEET
STEEL FRAME ONLY

BG
OVERHEAD COUNTER DOOR: 640 SERIES BY OVERHEAD
DOOR CORPORATION. 2" PANEL THICKNESS, ELECTRIC
OPERATION, FUSIBLE LINK, INTERIOR FACE MOUNT, SLIDE
LOCK, TWO COAT BAKE-ON POLYESTER FINISH (WHITE).

DOOR & FRAME ELEVATIONS (TYPES)

SCALE: 3/8" = 1'-0"

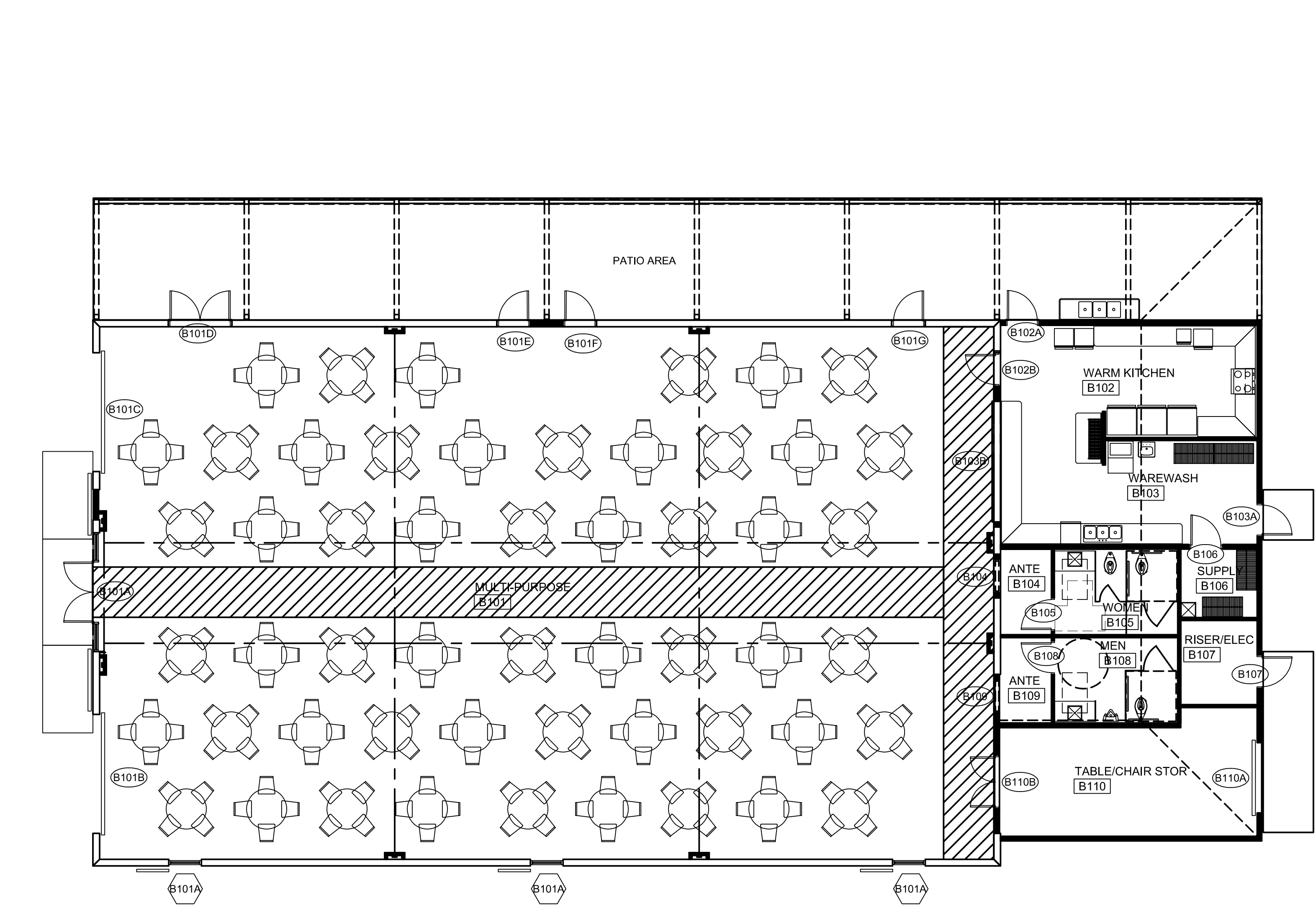

FLOOR PLAN: THE ACTIVITY BARN - PHASE 2
SCALE: 1/8" = 1'-0"

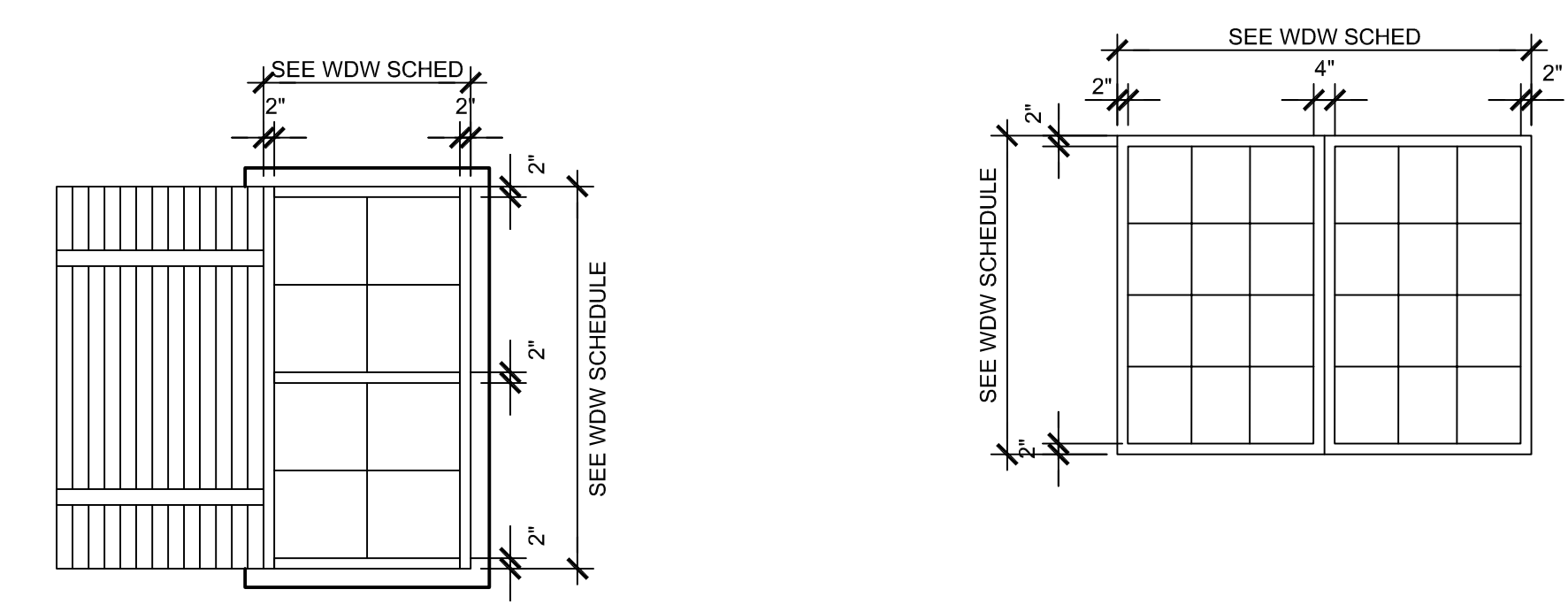

A
KAWNEER TRIFAB 451T
STOREFRONT SYSTEM
CAPTIONED 4 SIDES

B
KAWNEER TRIFAB 451T
STOREFRONT SYSTEM
CAPTIONED 4 SIDES

WINDOW ELEVATIONS (TYPES)

SCALE: 3/8" = 1'-0"

960 Sutton Road
FORSYTH, GEORGIA 31029
gary@gmarchitectllc.net
(478)-365-8976

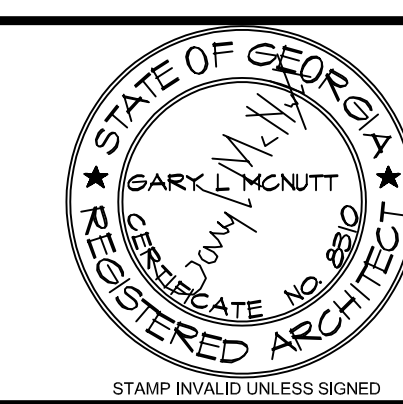

ARCHITECT
CONSULTANT



10641 HIGHWAY 36
COVINGTON, GA 30014
770.786.3031

**Retrofit & Renovations for
Madison Methodist Church
Phase 2: Activity Barn**
Madison, Georgia 30650
1091 Confederate Highway

JOB NO.:	02601
DRAWN BY:	GM
CHECKED BY:	GM
DESCRIPTION:	SCH-REVIEW-P2
DATE:	12.15.26
DESCRIPTION:	DD-REVIEW
DATE:	00.00.26
DESCRIPTION:	CD-REVIEW
DATE:	03.12.26
DESCRIPTION:	BID-CONSTRUCTION
DATE:	00.00.26
REVISIONS:	
1	00.00.26
2	
3	
4	
5	
6	
7	
8	
9	
10	