

THIS BLOCK RESERVED FOR THE CLERK OF THE SUPERIOR COURT.

SURVEYORS CERTIFICATION
This plat is a retracement of an existing parcel or parcels of land and does not subdivide or create a new parcel or make any changes to any real property boundaries. The recording information of the documents, maps, plats, or other instruments which created the parcel or parcels are stated hereon. RECORDATION OF THIS PLAT DOES NOT IMPLY APPROVAL OF ANY LOCAL JURISDICTION, AVAILABILITY OF PERMITS, COMPLIANCE WITH LOCAL REGULATIONS OR REQUIREMENTS, OR SUITABILITY FOR ANY USE OR PURPOSE OF THE LAND. Furthermore, the undersigned land surveyor certifies that this plat complies with the minimum technical standards for property surveys in Georgia as set forth in the rules and regulations of the Georgia Board of Registration for Professional Engineers and Land Surveyors and as set forth in O.C.G.A. Section 5-9-47.

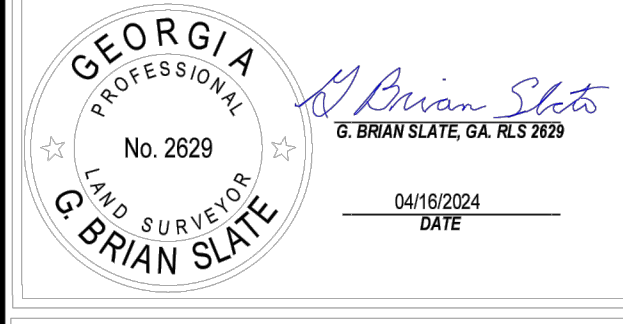

THE PURPOSE OF THIS PLAT IS A BOUNDARY RETRACEMENT TOPOGRAPHICAL AND EXISTING CONDITIONS SURVEY ON AN EXISTING TRACT KNOWN AS TAX MAP PARCEL 036 B, MORGAN COUNTY, GEORGIA. THE SOURCE OF TITLE DESCRIPTION IS PER DB 723, PG 188, AFORESAID COUNTY. THE CURRENT OWNER, AS PER THE INDICATED TAX RECORDS IS MADISON METHODIST CHURCH, INC. THE PROPERTY ADDRESS IS 1218 DIXIE HIGHWAY, MADISON, GEORGIA, 30650.

SURVEY NOTES:
1. THE DATUM FOR THIS SITE WAS ESTABLISHED UTILIZING GLOBAL POSITIONING SYSTEMS AND THE BASED REFERENCE FRAME ON POSITIONAL VALUES FOR THE VIRTUAL REFERENCE STATION NETWORK DEVELOPED BY EGPS SOLUTIONS. THE HORIZONTAL DATUM IS GEORGIA STATE PLANE WEST ZONE COORDINATE SYSTEM, NORTH AMERICAN DATUM OF 1983 (NAD83).
2. THE VERTICAL DATUM IS NORTH AMERICAN VERTICAL DATUM OF 1988 (NAV88).
3. THIS SURVEY WAS PREPARED WITHOUT THE BENEFIT OF AN ABSTRACT OF TITLE. SUBJECT AND ADJACENT PROPERTY OWNERS DEED AND PLAT REFERENCES WERE OBTAINED BY GEORGIA CIVIL, INC. AND ARE NOT GUARANTEED AS TO ACCURACY NOR COMPLETENESS.
4. ALL DEED AND PLAT BOOK REFERENCES AS SHOWN HEREON ARE RECORDED IN THE CLERK OF SUPERIOR COURT'S OFFICE OF MORGAN COUNTY, GEORGIA.
5. STRUCTURES VISIBLE ON THE DATE OF THE SURVEY ARE AS SHOWN HEREON. ALL LOCATIONS ARE ACCURATE ONLY WHERE DIMENSIONED.
6. THIS PROPERTY IS LOCATED IN ZONE "X" AND IS NOT SHOWN TO BE LOCATED WITHIN THE LIMITS OF A SPECIAL FLOOD HAZARD AREA, PER THE FEDERAL EMERGENCY MANAGEMENT AGENCY'S FLOOD INSURANCE RATE MAP NO. 132110205B; EFFECTIVE DATE: 01/09/2023. THIS STATEMENT IS BASED ON GRAPHICALLY LOCATING THE SUBJECT PROPERTY ON SAID MAP. NO ADDITIONAL FIELD WORK HAS BEEN COMPLETED TO VERIFY THIS INFORMATION.
7. THE CERTIFICATION, AS SHOWN HEREON, IS PURELY A STATEMENT OF PROFESSIONAL OPINION BASED ON KNOWLEDGE, INFORMATION AND BELIEF, BASED ON EXISTING FIELD EVIDENCE AND DOCUMENTARY EVIDENCE AVAILABLE. THE CERTIFICATION IS NOT AN EXPRESSED OR IMPLIED WARRANTY OR GUARANTEE. THE TERM "CERTIFICATION" AS USED IN RULE 100-6-09(2) AND (3) AND RELATING TO PROFESSIONAL ENGINEERING OR LAND SURVEYING SERVICES, AS DEFINED IN O.C.G.A. 43-15-2(6) AND (11), SHALL MEAN A SIGNED STATEMENT BASED UPON FACTS AND KNOWLEDGE KNOWN TO THE REGISTRANT AND IS NOT A GUARANTEE OR WARRANTY, EXPRESSED OR IMPLIED.
8. THIS SURVEY COMPLIES WITH BOTH THE RULES OF THE GEORGIA BOARD OF REGISTRATION FOR PROFESSIONAL ENGINEERS AND LAND SURVEYORS AND THE OFFICIAL CODE OF GEORGIA ANNOTATED (O.C.G.A.) 15-6-47. IN THAT WHERE A CONFLICT EXISTS BETWEEN THOSE TWO SETS OF SPECIFICATIONS, THE REQUIREMENTS OF LAW PREVAIL.
9. UTILITIES, AS SHOWN HEREON, ARE BASED ON ABOVE GROUND VISIBLE EVIDENCE ONLY. THE SURVEYOR DOES NOT WARRANT THE EXACT SIZE, TYPE, LOCATION, ACCURACY OR THOROUGHNESS OF THE INFORMATION CONCERNING THE ABOVE/UNDERGROUND UTILITIES AND STRUCTURES. NO GUARANTEE IS MADE THAT OTHER UTILITIES MAY EXIST ON THE SITE, THAT MAY NOT BE SHOWN.
10. THE FIELD DATA UPON WHICH THIS MAP OR PLAT IS BASED HAS AN AVERAGE RELATIVE ACCURACY OF 0.03 FEET AT A 95% CONFIDENCE LEVEL AND HAS NOT BEEN ADJUSTED. THIS PLAT HAS BEEN CALCULATED FOR CLOSURE AND HAS BEEN FOUND TO BE ACCURATE WITHIN ONE FOOT IN 265,389 FEET. THE LINEAR AND ANGULAR MEASUREMENTS SHOWN ON THIS PLAT WERE OBTAINED BY UTILIZING A GOMAX ROBOTIC TOTAL STATION AND A CARLSON BR7 GPS UNIT (MFG#192, 188.10.1) IN THE PREPARATION OF THIS PLAT. THE FIELD MEASUREMENTS WERE COMPLETED ON 01/19/2024.
11. THIS PROPERTY IS SUBJECT TO ALL RIGHT OF WAYS AND EASEMENTS OF RECORD.
12. IN MY OPINION, THIS IS A CORRECT REPRESENTATION OF THE LAND PLATTED AND HAS BEEN PREPARED IN CONFORMITY WITH THE MINIMUM STANDARDS AND REQUIREMENTS OF LAW.
13. THIS PLAT HAS BEEN COMPLETED FOR THE USE AND PURPOSE OF THE CLIENT ASCRIBED AND CONTRACTED WITH HEREON. ALL OTHER PARTIES ARE SUBSEQUENTLY PUT ON NOTICE AS TO THE LIMITED DEGREE OF RELIANCE UPON THIS PLAT BY THIRD PARTIES.
14. THE TOPOGRAPHICAL INFORMATION, SHOWN HEREON, IS BASED ON FIELD SURVEYED DATA. ELEVATIONS SHOWN ARE BASED ON NAVD83 (COMPUTED USING GEOID19).



Know what's below. Call before you dig.

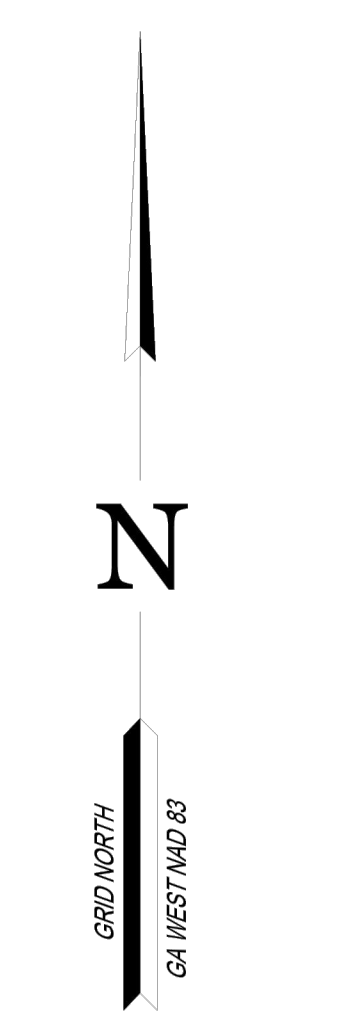

LEGEND

○	COMPUTED POINT
●	IRON PIN FOUND
⊕	IRRIGATION CONTROL VALVE
⊙	FIRE HYDRANT
⊗	GAS METER
⊕	ELECTRIC METER
●	PP = POWER POLE
○	WELL
⊗	WATER PUMP
⊕	ELECTRIC TRANSFORMER
⊕	UNKNOWN MAN HOLE
⊕	SANITARY SEWER MAN HOLE
⊕	CLEAN OUT
⊕	GRATE INLET
⊕	DECIDUOUS TREE
⊕	EVERGREEN TREE
⊕	WATER VALVE
⊕	STORM PIPE
—OHP—	OVERHEAD POWER
—SS—	SANITARY SEWER LINE
-X-	FENCE LINE
A	ARC LENGTH
APPROX	APPROXIMATE
B.S.L.	BUILDING SETBACK LINE
CB	CHORD BEARING
CD	CHORD DISTANCE
CMP	CORRUGATED METAL PIPE
CONC	CONCRETE
DB	DEED BOOK
EX	EXISTING
FES	FLARED END STRUCTURE
FFE	FINISH FLOOR ELEVATION
FH	FIRE HYDRANT
GI	GRATE INLET
GM	GAS METER
HVAC	HEATING & AIR CONDITIONER UNIT
HWF	HOG WIRE FENCE
ICV	IRRIGATION CONTROL VALVE
NF	NOW OR FORMERLY
NTS	NOT TO SCALE
⊕	PROPERTY LINE
PB	PLAT BOOK
PG	PAGE
POB	POINT OF BEGINNING
RW	RIGHT OF WAY
RFB	RESAR FOUND
RCP	REINFORCED CONCRETE PIPE
SF	SQUARE FEET
SMH	SANITARY SEWER MANHOLE
TMP	TAX MAP PARCEL
WV	WATER VALVE

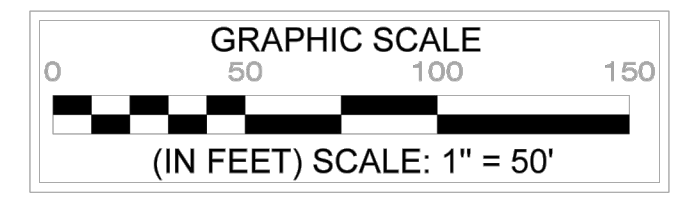

gc
georgia civil
CIVIL ENGINEERING
LANDSCAPE ARCHITECTURE
LAND SURVEYING
311 North Main Street, Unit C, Suite 101
P.O. Box 896 | Madison, GA 30650
P. 706.342.1104 | C. 706.201.0996
www.georgiacivil.com

GEORGIA PROFESSIONAL SURVEYOR
No. 2629
G. BRIAN SLATE
SURVEYED BY:
G. BRIAN SLATE, RLS#2629
C. 706.201.0996
bslate@georgiacivil.com

MADISON METHODIST CHURCH, INC.
13,380 ACRES
IN LAND LOT 138 OF THE 20th LAND DISTRICT
IN THE 27th G.M. DISTRICT
MORGAN COUNTY, GEORGIA

CREW CHIEF: TG
SURVEYED: 01/19/2024
PROJECT #: 24GC006
DRAWING DATE: 04/16/2024
DRAWN BY: GBS
CHECKED BY: GBS

REVISIONS
DATE: DESCRIPTION:

© Copyright 2024 georgia civil, inc.
This document and its reproduction are the property of Georgia Civil, Inc. and may not be reproduced, published or used in whole or in part without the written consent of Georgia Civil, Inc.

Sheet Title
**BOUNDARY
RETRACEMENT
TOPOGRAPHICAL
AND
EXISTING
CONDITIONS
SURVEY**

Sheet Number
TS-1