

VARIABLE AIR VOLUME BOX SCHEDULE (VAV)

Table with columns: PLAN DESIGNATION, MANUFACTURER MODEL NO., ASSOCIATED EQUIPMENT, INLET SIZE (IN.), LOCATION, MAXIMUM AIR FLOW (CFM), MINIMUM AIR FLOW (CFM), REHEAT AIRFLOW (CFM), AIR PRESSURE DROP (IN. W.C.), COIL DATA (CAPACITY, EAT/LAT, EWT/LWT, VOLTS/PHASE, AMPS), MAXIMUM NC, NOTES.

- 1. PROVIDE INSULATED ACCESS DOOR IN VAV BOX FOR VIEWING DAMPER AND COIL.
2. COORDINATE VAV SUPPLY AIR DUCT TRANSITION WITH VAV NECK CONNECTION SIZE.
3. INLET STATIC PRESSURE SHALL BE 1.0 (I.N. W.G.).
4. PROVIDE SCR OR OTHER FORM OF VARIABLE ELECTRIC COIL.
5. PROVIDE HI-LIMIT DISCHARGE STAT.
6. PROVIDE ELECTRICAL DISCONNECT SWITCH.
7. PROVIDE SPACE TEMPERATURE SENSOR.

REGISTER, GRILLE, AND DIFFUSER SCHEDULE

Table with columns: PLAN DESIGNATION, MANUFACTURER MODEL NO., TYPE, NECK SIZE, MAX. N.C. LEVEL, FACE SIZE (IN.), MATERIAL, NOTES.

GENERAL NOTES:

- 1. A REGISTER IS DEFINED AS A GRILLE WITH A FACE DAMPER.
2. FACE SIZE IS DEFINED AS THE MAXIMUM OUTSIDE DIMENSIONS OF THE AIR INLET/OUTLET. REFER TO DIAGRAMS CONTAINED WITHIN FOR ADDITIONAL INFORMATION.
3. CONTRACTOR SHALL VERIFY CEILING TYPE PRIOR TO ORDERING AIR INLETS AND OUTLETS. PROVIDE ALL REQUIRED BRACKETS, FLANGES, SURFACE PLATES, AND FRAMES TO MOUNT THE DEVICE. REFER TO ARCHITECTURAL CEILING PLANS FOR CEILING TYPES.
4. SUBMIT A SEPARATELY FROM TECHNICAL DATA A COLOR CHART FOR COLOR AND FINISH SELECTION.

DEVICE TAG

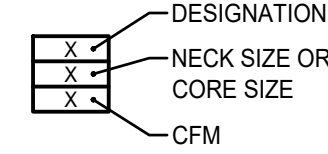

CEILING DIFFUSER

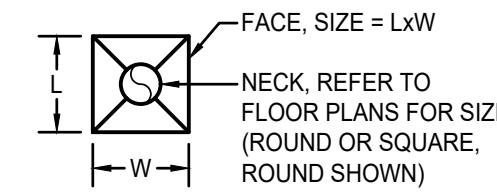

CEILING DIFFUSER w/ CORE

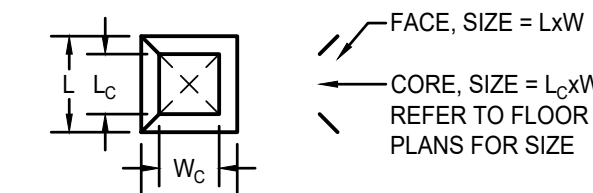

REGISTER / GRILLE

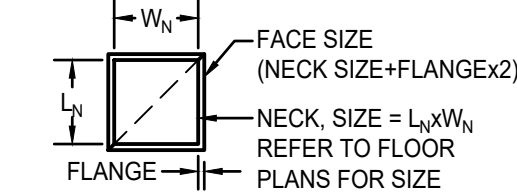

AIR CONDITIONING UNIT SCHEDULE (RTU)

Table with columns: PLAN DESIGNATION, MANUFACTURER MODEL NO., ASSOCIATED EQUIPMENT, MAXIMUM UNIT WEIGHT (LBS), AIR FLOW (CFM), MIN O.A. CFM (OCCUPIED), TOTAL S.P. (IN. W.C.), EXTERNAL S.P. (IN. W.C.), EER, SEER, IEER, DIX COOLING SECTION (TOTAL CAP., SENSIBLE CAP., EAT, LAT), HEATING (HEAT PUMP) (23 F AMBIENT) (TOTAL CAP., EAT, LAT), OPERATING FAN HP, FAN HP, NO. OF COMPRESSORS, REFRIGERANT TYPE, REFRIGERANT CHARGE TOTAL (LB), TOTAL UNIT ELECTRIC DATA (MCA, MOP, SCCR, VOLTS/PHASE), NOTES.

NOTES:

- 1. PROVIDE SINGLE VARIABLE FREQUENCY DRIVE FOR SUPPLY WITH INTEGRAL HAND-OFF-AUTO SELECTION SWITCH AND LOCKABLE DISCONNECT.
2. PROVIDE 2" MERV-13 FILTERS.
3. PROVIDE HINGED ACCESS DOOR AND REMOVABLE FILTERS.
4. FAN STATIC PRESSURES TO BE BASED ON FILTERS IN REPLACEMENT CONDITION (2" WC ALLOWANCE).
5. PROVIDE NON-FUSED, UNIT MOUNTED DISCONNECT BY MANUFACTURER.
6. PROVIDE POWER EXHAUST POWERED BY UNIT SINGLE POINT POWER CONNECTION.
7. PROVIDE HINGED ACCESS DOORS.
8. UNIT TO BE FACTORY FABRICATED AS ONE UNIT BY MANUFACTURER.
9. PROVIDE DOOR KILL SWITCHES ASSOCIATED WITH THE FAN SECTION ACCESS DOOR.
10. PROVIDE WITH BACKNET CAPABLE UNIT MOUNTED STAND-ALONE CONTROLLER.
11. PROVIDE THYBAR WIND RATED CURB ADAPTOR IN COMPLIANCE WITH THE 2020 NEW YORK STATE BUILDING CODE AND ASCE 7.
12. PROVIDE ECONOMIZER WITH ENTHALPY CONTROL.
13. PROVIDE MULTI ZONE VAV CONTROL.
14. PROVIDE POWERED 15A CONVENIENCE OUTLET FROM SINGLE POINT POWER CONNECTION.
15. PROVIDE CLOGGED FILTER SWITCH AND CONDENSATE OVERFLOW SWITCH.
16. PROVIDE CONDENSER HAIL GUARDS.
17. UNIT SHALL BE PROVIDED WITH A VARIABLE SPEED COMPRESSOR MATCHED WITH VFD.
18. FACTORY LOCAL CONTROLS WITH VAV CAPABILITY.

LINEAR DIFFUSER SCHEDULE

Table with columns: PLAN DESIGNATION, MANUFACTURER MODEL NO., TYPE, MAX. STATIC PRESSURE (IN. WG), MAX. N.C. LEVEL, # OF SLOTS, SLOT WIDTH (IN), WITH PLENUM, PLENUM INLET SIZE (IN), OVERALL LENGTH (IN), THROW PATTERN, MATERIAL, NOTES.

GENERAL NOTES:

- 1. DIFFUSER SHALL BE SET SUCH THAT SLOT FACING EXTERIOR WALL/WINDOW HAS VERTICAL AIRFLOW, AND SLOT FACING THE INTERIOR OF THE BUILDING HAS HORIZONTAL AIRFLOW.
2. CONTRACTOR SHALL VERIFY CEILING TYPE PRIOR TO ORDERING AIR INLETS AND OUTLETS. PROVIDE ALL REQUIRED BRACKETS, FLANGES, SURFACE PLATES, AND FRAMES TO MOUNT THE DEVICE. REFER TO ARCHITECTURAL CEILING PLANS FOR CEILING TYPES.
3. SUBMIT A SEPARATELY FROM TECHNICAL DATA A COLOR CHART FOR COLOR AND FINISH SELECTION.

DEVICE TAG

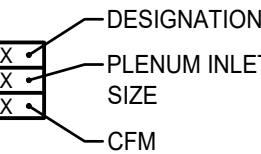

LINEAR DIFFUSER

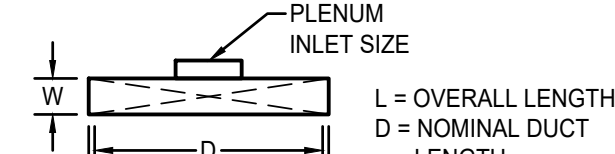

EXHAUST FAN SCHEDULE (EF)

Table with columns: PLAN DESIGNATION, MANUFACTURER MODEL NO., LOCATION, CONSTRUCTION TYPE, DISCHARGE CONFIGURATION, AIR FLOW RATE (CFM), EXTERNAL S.P. (IN. W.C.), FAN SPEED (RPM), INLET SONES, DRIVE TYPE, ELECTRICAL DATA (MOTOR BHP, MOTOR HP, VOLTS/PHASE), NOTES.

NOTES:

- 1. PROVIDE 24" ROOF CURB.
2. PROVIDE ECM WITH 0-10 VDC INPUT SIGNAL AND BALANCING KNOB.
3. PROVIDE FACTORY MOUNTED DISCONNECT SWITCH.
4. PROVIDE MOTORIZED BACK DAPT DAMPER WITH 24V ACTUATOR.
5. PROVIDE INSULATED MOTORIZED DAMPER.
6. PROVIDE COMBINATION MOTOR STARTER.
7. PROVIDE FAN MOUNTED SPEED CONTROLLER FROM MANUFACTURER.

CONSTRUCTION TYPE:

- GPF - GENERAL PURPOSE FAN
SRC - SPARK B RESISTANT CONSTRUCTION

DISCHARGE CONFIGURATION:

- CW - CLOCKWISE
UB - UP BLAST
DB - DOWN BLAST

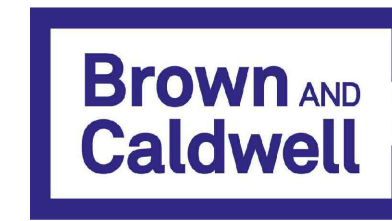

BROWN AND CALDWELL
900 HAMMOND DRIVE, SUITE 500
ATLANTA, GA 30328



THIS DRAWING IS NOT VALID FOR CONSTRUCTION PURPOSES UNLESS IT BEARS THE SEAL AND SIGNATURE OF A DULY REGISTERED PROFESSIONAL

60% DESIGN DOCUMENTS



NCWSA OFFICE ADDITION

REVISIONS

Table with columns: REV, DATE, DESCRIPTION

LINE IS 2 INCHES AT FULL SIZE

DESIGNED: CJP

DRAWN: CJP

CHECKED: NBN

CHECKED:

APPROVED: RFJ

FILENAME

BC PROJECT NUMBER

CLIENT PROJECT NUMBER

MECHANICAL SCHEDULES

DRAWING NUMBER M301